



GSE IN-ROOF SYSTEM™

BIPV system for photovoltaic panels

Installation Manual – UNIVERSAL Kit

V 13.2



MADE IN FRANCE

www.gseintegration.com



Contents

1.	Kit presentation	5
1.1	Presentation of the GSE In-Roof System™	5
1.2	Content of the kit	6
1.3	Tools required	7
1.4	GSE PORTRAIT Frame v.2012 and v.2020	8
1.5	GSE LANDSCAPE Frame	9
1.6	GSE PORTRAIT HALF-FRAME v.2022	10
1.7	GSE Clamps	11
2.	Building site preparation	12
2.1	Climatic Conditions	12
2.2	Position on the roof	12
2.3	Determine wind pressure of the project	13
3.	Installation	12
3.1	Overall presentation of the system	14
3.2	Preparation of the roof covering	15
3.3	Positioning of the support battens	16
3.4	Sealing strip installation	22
3.5	GSE Frames installation	23
3.6	Lateral flashings installation	26
3.7	PV modules installation	28
3.8	Top flashing installation	33
3.9	Specific case: PV array with inner/outer angles	37
3.10	Connection to the roof covering	39
4.	Maintenance and Servicing	40
4.1	Verification	40
4.2	Module replacement	40
5.	Assistance and Contact	41
5.1	Training session	41
5.2	Technical assistance	41
6.	Certifications et warranties	41
6.1	Technical assessments	41
6.2	Fire test	41

1. Kit Presentation

1.1 Presentation of the GSE In-Roof System™

GSE In-Roof System™ enables modules installation on every type of roof covering (curved tiles, interlocking, flat tiles, slates, metal, zinc, trapezoidal), as well as on new buildings like retrofit buildings.

The mounting system may be installed in a **portrait or landscape orientation**, with a specific frame for each format, suitable for small installations (less than 3 kWp) and large roofs.

GSE In-Roof System™ must be installed on the wooden or metallic substructure of the buildings and mounted on specific battens, adapted to climatic conditions. It can be mounted on slopes between **12° and 50°**.

Complementary manuals available :

- GSE INTEGRATION In-Roof v. TS
- GSE INTEGRATION In-Roof v. A
- GSE INTEGRATION In-Roof v. TN
- GSE INTEGRATION In-Roof Roof-Windows

You can also watch our installation video by clicking on the picture below:



Or you can find this video on our website by following this link:

<https://www.gseintegration.com/en/solutions/gse-in-roof-system/>

1.2 Content of the kit

MOUNTING FRAMES



MOUNTING CLAMPS

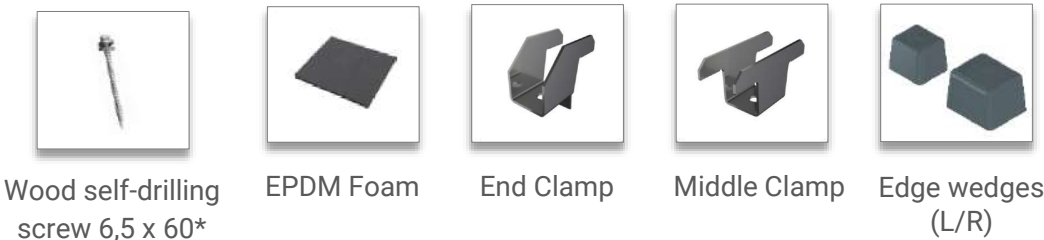

FLASHINGS

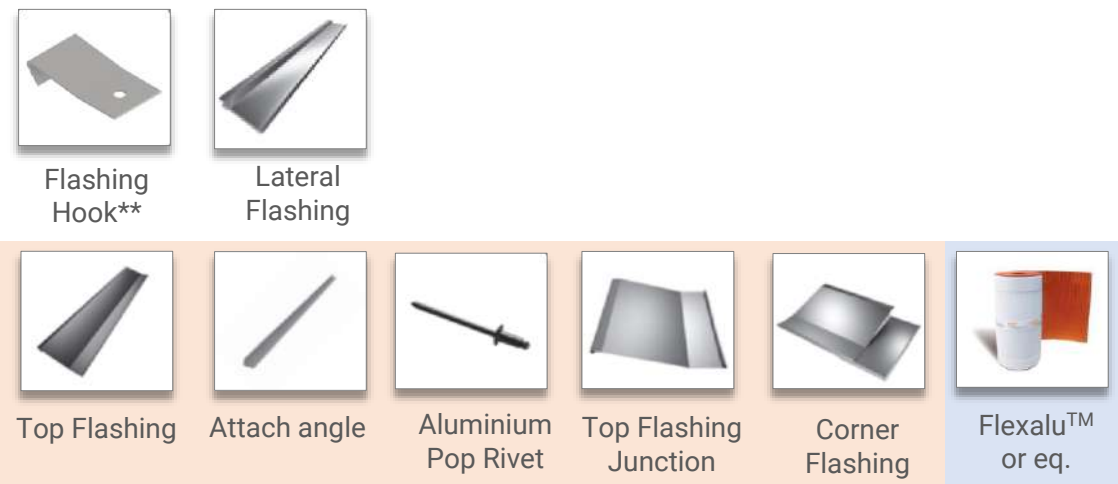

OPTION 1

WATERPROOFING



OPTION 2

* A 60 mm length screw is adapted to an installation with vertical counter battens and horizontal support battens. In case of a different installation principle, it is the responsibility of the installer to use a screw with adapted length.

** Nails / screws for fixing the flashing hook not sourced by GSE Integration

1.3 Tools required

SCREWDRIVER



Adjustable tightening torque mandatory

DRILL BITS WOOD AND METAL OF 10MM



HEX BIT 8MM



AVIATION SNIP



RIVET GUN



HAMMER



MEASURING TAPE



CHALK LINE



MARKING ACCESSORIES



White marker, pencil, etc.

1.4 GSE PORTRAIT Frame v.2012 and v.2020

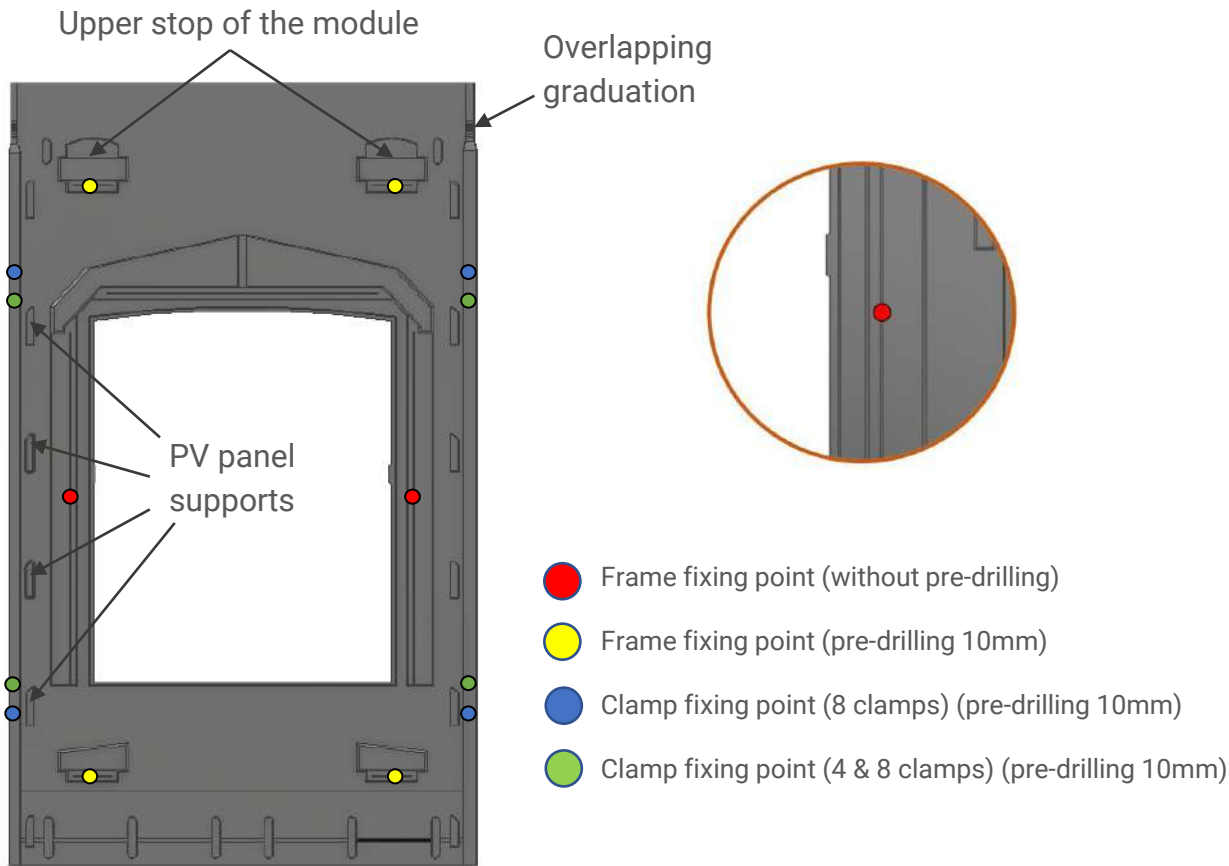

PORTRAIT FRAME REFERENCES – MODULES SIZES



↑ Height Tolerance

← Width Tolerance

		PV module dimensions					
		Height			Width		
		Réf.	Min. tolerated	Min. suggested	Max.	Min. suggested	Max.
PORTRAIT	Version 2012	1580_808	1500	1540	1680	803	808
		1575_1046	1495	1535	1675	1041	1046
		1575_1053	1495	1535	1675	1048	1053
		1575_1082	1495	1535	1675	1077	1082
		1640_992	1560	1600	1740	987	992
		1640_1001	1560	1600	1740	996	1001
		1640_1001_33	1560	1600	1740	996	1001
	1686-1700_1016	1605	1645	1755	1011	1016	
	Version 2020	1710_995	1630	1670	1780	990	995
		1710_1000	1630	1670	1780	995	1000
		1710_1005	1630	1670	1780	1000	1005
		1710_1010	1630	1670	1780	1005	1010
		1710_1020	1630	1670	1780	1015	1020
		1710_1025	1630	1670	1780	1020	1025
		1710_1030	1630	1670	1780	1025	1030
		1710_1040	1630	1670	1780	1035	1040
		1710_1045	1630	1670	1780	1040	1045
		1710_1050	1630	1670	1780	1045	1050
		1710_1055	1630	1670	1780	1050	1055

1.5 GSE LANDSCAPE Frame

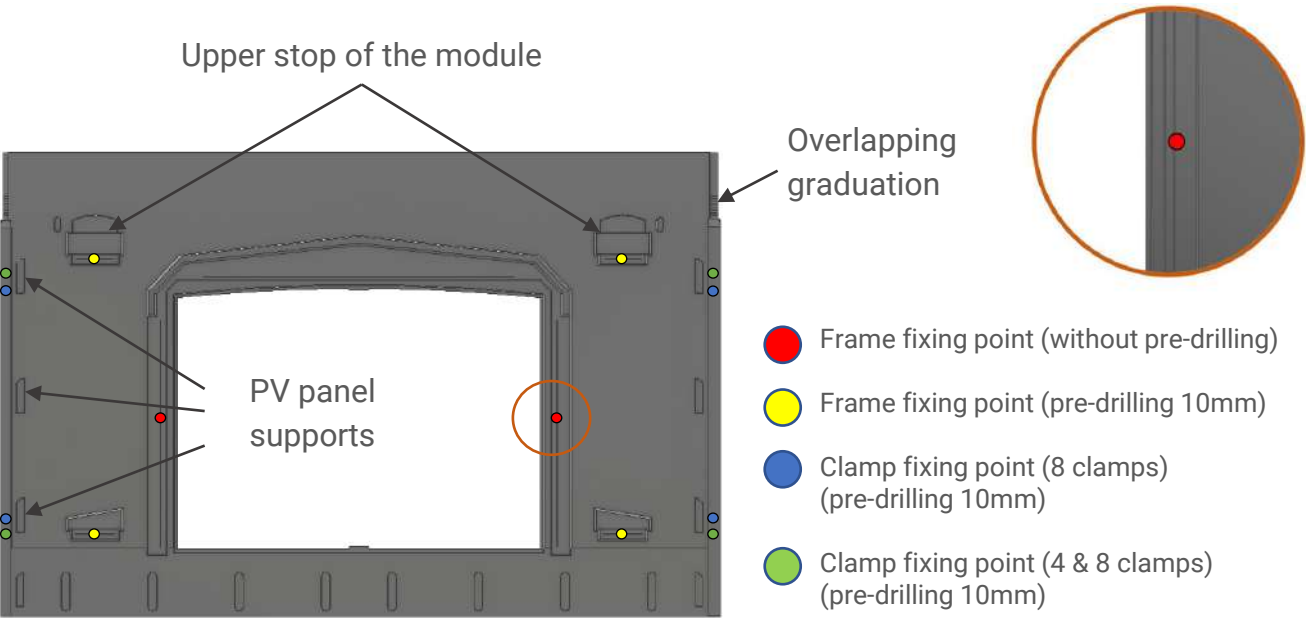

LANDSCAPE FRAME REFERENCES – MODULES SIZES

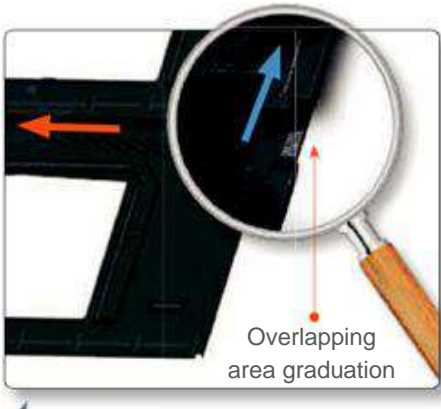

↑ Height Tolerance

← Width Tolerance

		PV module dimensions					
		Height			Width		
		Réf.	Min. tolerated	Min. suggested	Max.	Min. suggested	Max.
LANDSCAPE	Version 2012	1559_1082	1002	1042	1182	1554	1559
		1575_1082	1002	1042	1182	1570	1575
		1580_808	728	768	908	1575	1580
		1640_992	912	952	1092	1635	1640
		1650_992	912	952	1092	1645	1650
		1660_992	912	952	1092	1655	1660
		1670_992	912	952	1092	1665	1670
		1675_992_33	912	952	1092	1670	1675
		1680_992	912	952	1092	1675	1680
		1686_1016	912	952	1092	1681	1686
		1700_1016	912	952	1092	1695	1700
	Version 2020	1665_1020	940	980	1120	1660	1665
		1675_1020	940	980	1120	1670	1675
		1680_1020	940	980	1120	1675	1680
		1685_1020	940	980	1120	1680	1685
		1690_1020	940	980	1120	1685	1690
		1695_1020	940	980	1120	1690	1695
		1700_1020	940	980	1120	1695	1700
		1705_1020	940	980	1120	1700	1705
		1720_1020	940	980	1120	1715	1720
		1740_1020	940	980	1120	1735	1740

1.6 GSE PORTRAIT HALF-FRAME v.2022

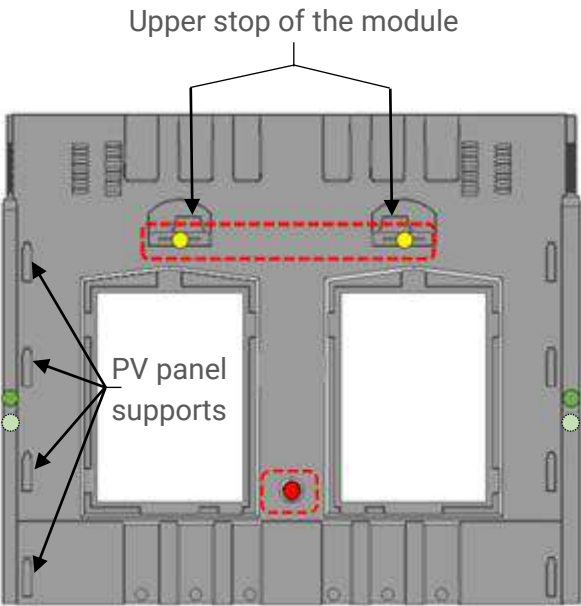

- Frame fixing point
(already placed, without pre-drilling)
- Frame fixing point
(already pre-drilled at 10mm)
- Clamp fixing point (4 & 8 clamps) (lateral interlocking needing a 10mm pre-drilling)

HALF-PORTRAIT FRAME REFERENCES – MODULES SIZES

Overlapping area graduation

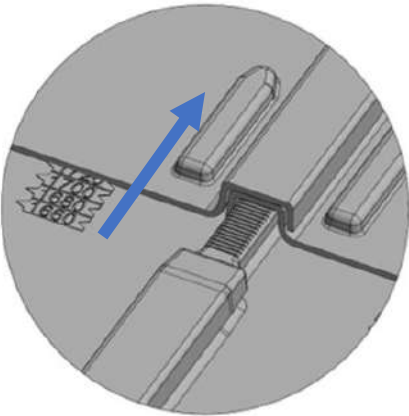

		PV module dimensions					
		Height			Width		
		Réf.	Min. tolerated	Min. suggested	Max.	Min. suggested	Max.
PORTRAIT	Version 2022	DPo_1650_995	1570	1610	1800	991	995
		DPo_1650_1070	1570	1610	1800	1066	1070
		DPo_1650_1100	1570	1610	1800	1096	1100
		DPo_1650_1135	1570	1610	1800	1131	1135
		DPo_1650_1140	1570	1610	1800	1136	1140
		DPo_1650_1145	1570	1610	1800	1141	1145
		DPo_1650_1160	1570	1610	1800	1156	1160
		DPo_1840_995	1760	1800	1990	991	995
		DPo_1840_1020	1760	1800	1990	1016	1020
		DPo_1840_1030	1760	1800	1990	1026	1030
		DPo_1840_1040	1760	1800	1990	1036	1040
		DPo_1840_1045	1760	1800	1990	1041	1045
		DPo_1840_1050	1760	1800	1990	1046	1050
		DPo_1840_1070	1760	1800	1990	1066	1070
		DPo_1840_1100	1760	1800	1990	1096	1100
		DPo_1840_1135	1760	1800	1990	1131	1135
		DPo_1840_1140	1760	1800	1990	1136	1140
		Dpo_2030_995	1950	1990	2180	991	995
		Dpo_2030_1050	1950	1990	2180	1046	1050
		Dpo_2030_1055	1950	1990	2180	1051	1055
		Dpo_2030_1135	1950	1990	2180	1131	1135
		Dpo_2030_1305	1950	1990	2180	1301	1305

*Certification of new XXL 2030 Frames currently in process.

1.7 GSE Clamps

END CLAMP

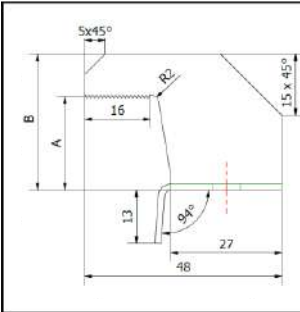

Description	A (mm)	B (mm)
End Clamp H16	17,8	27,8
End Clamp H19	20,8	30,8
End Clamp H21	22,8	32,8
End Clamp H23	24,8	34,8
End Clamp H26	27,8	37,8
End Clamp H27	28,8	38,8
End Clamp H31	32,8	42,8

MIDDLE CLAMP

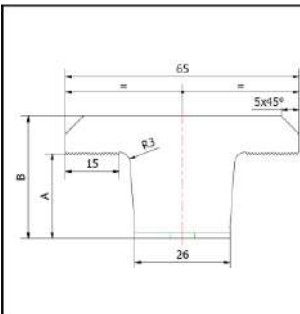

Description	A (mm)	B (mm)
Middle Clamp H16	18,6	28,6
Middle Clamp H19	21,6	31,6
Middle Clamp H21	23,6	33,6
Middle Clamp H23	25,6	35,6
Middle Clamp H26	28,6	38,6
Middle Clamp H27	29,6	39,6
Middle Clamp H31	33,6	43,6

CORRELATION CLAMPS / MODULES THICKNESS

Po et Pa 2020

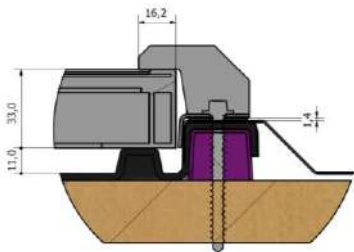

DPo 2022

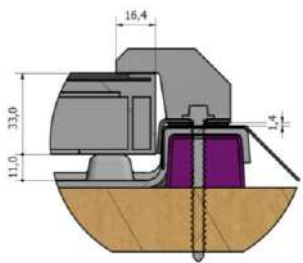

Clamps Size	Module thickness (mm)		
	GSE In-Roof V2012	GSE In-Roof V2012 – P33	GSE In-Roof V2020 V2022
H16	35-37 mm	32-34 mm	30-32 mm
H19	38-39 mm	35-36 mm	33-34 mm
H21	40-41 mm	37-38 mm	35-36 mm
H23	42-44 mm	39-41 mm	37-39 mm
H26	45-46 mm	42-43 mm	40-41 mm
H27	47-48 mm	44-45 mm	42-43 mm
H31	50 mm	47-49 mm	45-47 mm

INFO : Find the complete table of correlation on our website by following this link:
<https://www.gseintegration.com/wp-content/uploads/2022/03/GSE-In-Roof-Evolution-2020-EN-v10-1.pdf>

2. Building site Preparation

The installer must proceed to a measurement work beforehand, in order to guarantee the durability and performance of the PV array installed. Climatic conditions of the project (ie. wind and snow¹) and PV array layout should be considered according to current regulations (Eurocodes and BS 5534).

This data will help to check if the system is suitable for the project conditions. The thickness of the support battens must be adapted to the roof battens to ensure the junction with the roof covering is watertight.

2.1 Climatic Conditions

Climatic load according to Eurocode 1 and BS 5534 :



Geographical wind zone	Wind speed (m/s)	Design Wind Pressure (kN/m²)
1	22	0,820
2	24	0,975
3	26	1,150
4	28	1,330
5	30	1,600

Maximum design wind uplift resistance : **3,44 kN/m²**
(According to MCS 012 KIWA00041 certificate)

2.2 Position on the roof

The location of the PV array has an influence on the wind load value whether it is in the centre, on the edge or in the corner of the roof. The worst case should be taken into account.

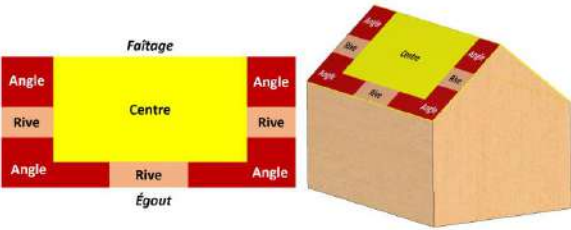

TWO-SLOPED ROOF

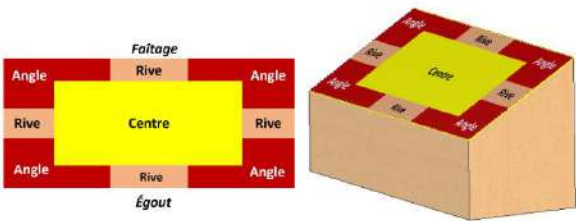

ONE-SLOPED ROOF

¹The seismic resistance of the GSE In-Roof System is validated on the whole European territory. This criterion is not to be taken into account.

2.3 Determine wind pressure of the project

To calculate the wind load on the PV array, you need to priorly know the following parameters:

- Location of the project
 - Altitude
 - Type of terrain
 - Distance from the shoreline
- Ridge height
 - Roof pitch
 - Roof zone (Centre, Edge, Corner)

Ideally, climatic load (and especially wind load) should be calculated for each project, but you can refer to the tables below, if all conditions matches with those of the project.

Fixed Conditions:

- Terrain category: **Country terrain** (including Town Terrain)
- Distance from the shoreline: **10 km**
- Battens dimension: **25 x 50mm**

GSE In-Roof Wind Uplift Resistance
(MCS012 Testing):

- 4 Clamps: 2,07 kN/m²

- 8 Clamps: 3,44 kN/m²

1st case: Roof pitch ≥ 25°

Ridge Height	Location on the Roof	Zone 1 (Alt ≤ 250m)	Zone 2 (Alt ≤ 200m)	Zone 3 (Alt ≤ 130m)	Zone 4 (Alt ≤ 100m)	Zone 5 (Alt ≤ 50m)
6 m	Center	1,26 kN	1,38 kN	1,44 kN	1,58 kN	1,65 kN
	Edges	1,46 kN	1,60 kN	1,67 kN	1,83 kN	1,92 kN
	Corners	1,56 kN	1,72 kN	1,78 kN	1,96 kN	2,05 kN
8 m	Center	1,37 kN	1,51 kN	1,57 kN	1,72 kN	1,80 kN
	Edges	1,59 kN	1,75 kN	1,82 kN	2,00 kN	2,09 kN
	Corners	1,71 kN	1,87 kN	1,95 kN	2,14 kN	2,24 kN
10 m	Center	1,43 kN	1,57 kN	1,63 kN	1,79 kN	1,88 kN
	Edges	1,66 kN	1,82 kN	1,90 kN	2,08 kN	2,18 kN
	Corners	1,78 kN	1,95 kN	2,03 kN	2,23 kN	2,33 kN

2nd case: Roof pitch ≥ 35°

Ridge Height	Location on the Roof	Zone 1 (Alt ≤ 250m)	Zone 2 (Alt ≤ 200m)	Zone 3 (Alt ≤ 150m)	Zone 4 (Alt ≤ 100m)	Zone 5 (Alt ≤ 50m)
6 m	Center	1,09 kN	1,19 kN	1,29 kN	1,36 kN	1,43 kN
	Edges	1,36 kN	1,49 kN	1,61 kN	1,71 kN	1,78 kN
	Corners	1,43 kN	1,57 kN	1,69 kN	1,79 kN	1,87 kN
8 m	Center	1,19 kN	1,30 kN	1,40 kN	1,49 kN	1,56 kN
	Edges	1,48 kN	1,63 kN	1,75 kN	1,86 kN	1,95 kN
	Corners	1,56 kN	1,71 kN	1,84 kN	1,95 kN	2,04 kN
10 m	Center	1,24 kN	1,36 kN	1,46 kN	1,55 kN	1,62 kN
	Edges	1,55 kN	1,69 kN	1,83 kN	1,94 kN	2,03 kN
	Corners	1,62 kN	1,78 kN	1,92 kN	2,04 kN	2,13 kN

3. Installation

3.1 Overall presentation of the system

OVERALL PRESENTATION OF THE INSTALLATION STEPS OF THE KIT :

- 1/ Positioning of the support battens
- 2/ GSE frames installation
- 3/ Flashings installation
- 4/ PV modules installation
- 5/ Connection of the roof covering on top bottom and lateral PV field

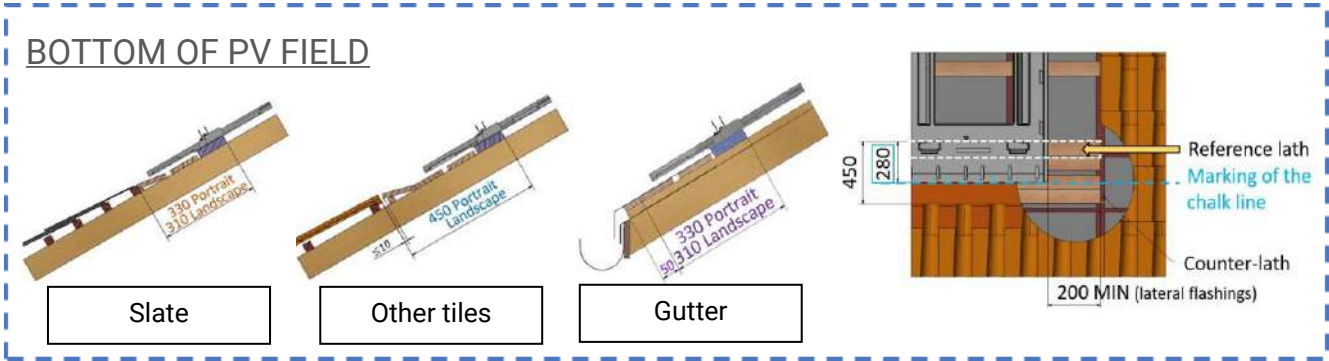
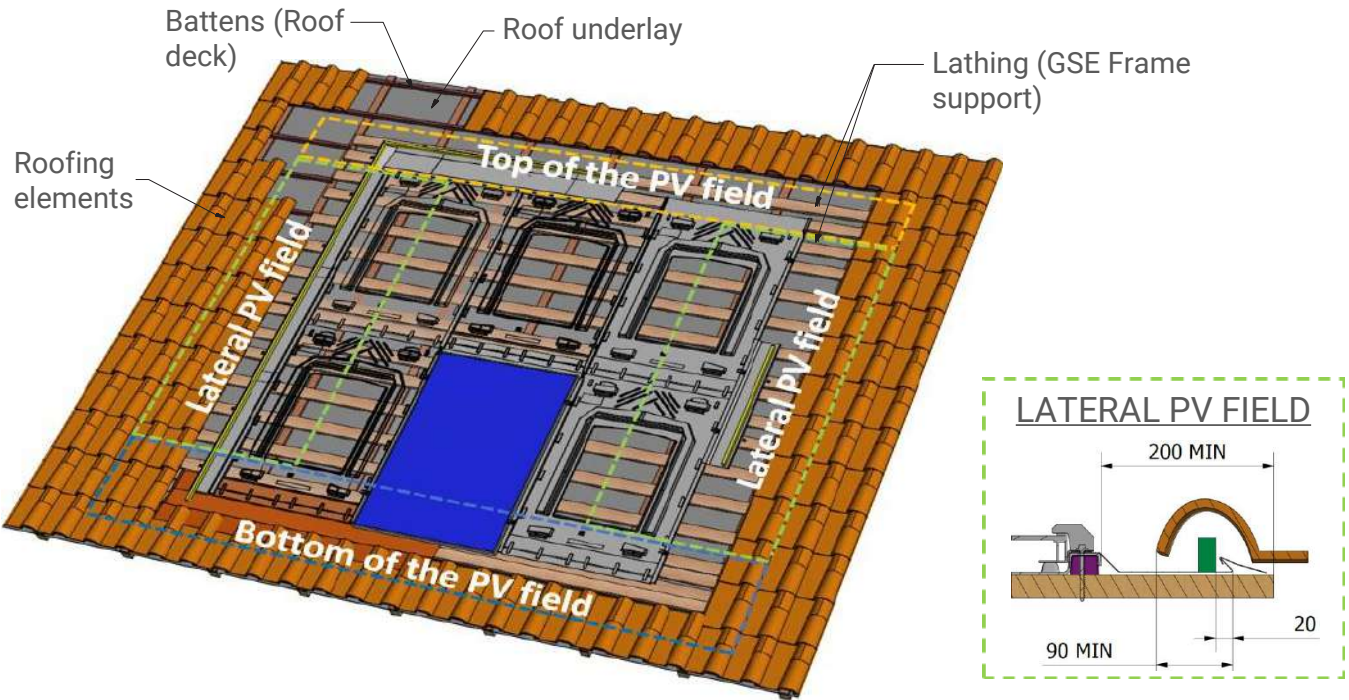
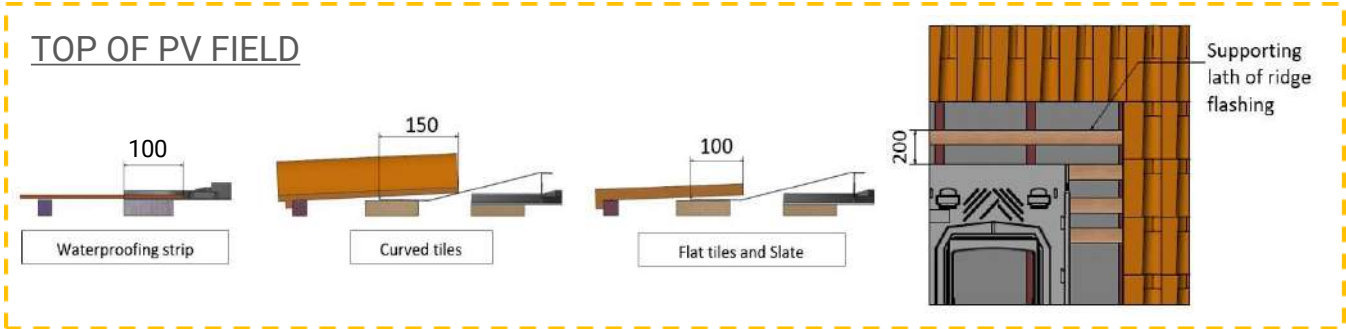

3.2 Preparation of the roof covering

3.2.1 Calculation of the PV array dimensions

INFO: Download our layout calculator on the « Downloads » section of our website
<https://www.gseintegration.com/en/downloads/> to determine the dimensions of your PV array.

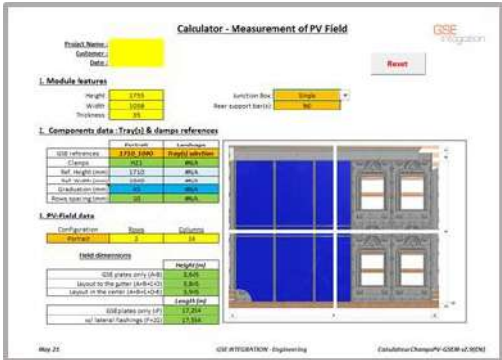

The dimensions of the PV array can be calculated using the GSE frame reference (see sections 1.4, 1.5 and 1.6 to determine the GSE frame compatible with the module):

A

Frames v.2012 and v.2020

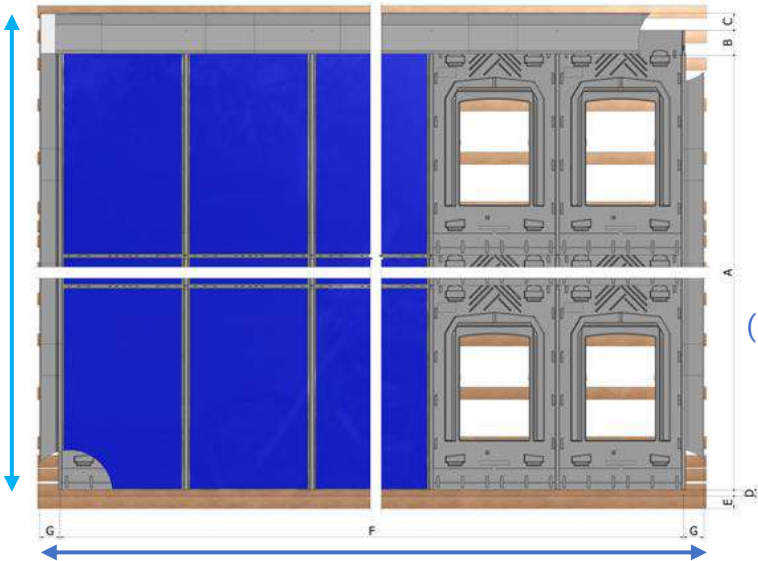

Array height (mm) =

$$((\text{Height Ref.} + \text{Graduation} + 10) \times \text{Nb. Lines}) + 160 + 150 + 50 + 100^2$$

$$A + B + C + D + E$$

Array width (mm) =

$$((\text{Width Ref.} + 36.5) \times \text{Nb. Columns}) + (2 \times 165)$$

$$F + 2 \times G$$

²If integrated in the centre, add a board to equalise with curve height (ie 3.4)

GSE frames - PORTRAIT

Height Ref	1580	1575	1575	1575	1640	1640	1686	1710	1710	1710	1710	1710	1710	1710	1710	1710	1710	1710
Width Ref	808	1046	1053	1082	992	1001	1016	995	1000	1005	1010	1020	1025	1030	1040	1045	1050	1055

GSE frames - LANDSCAPE

Height Ref	1082	1082	808	992	992	992	992	992	992	992*	992*	1020	1020	1020	1020	1020	1020	1020	1020	1020	1020
Width Ref	1559	1575	1580	1640	1650	1660	1670	1675	1680	1686	1700	1665	1675	1680	1685	1690	1695	1700	1705	1720	1740

* Landscape frames 1686_1016 and 1700_1016 have a reference height of 992.

B

Half-Frames v.2022

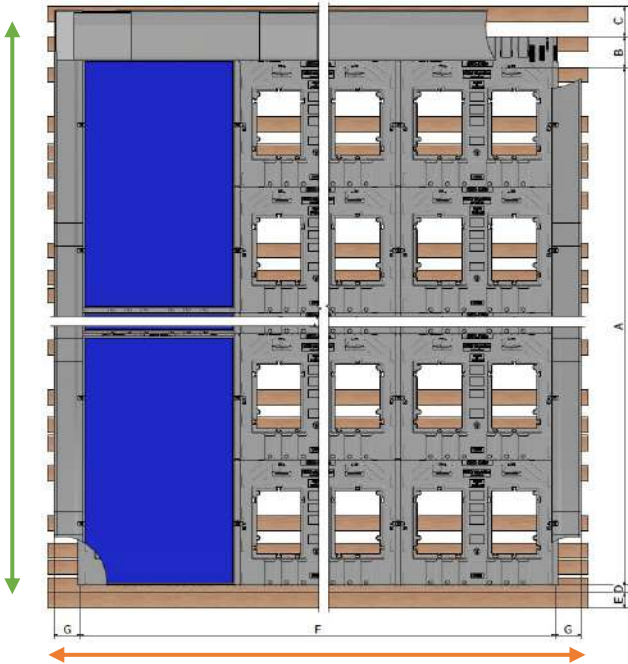

Array height (mm) =
 ((Height Ref. + Graduation + 10) x Nb. Lines) +
 160 + 150 + 50 + 100²

A

+

B

+

C

+

D

+

E

Array width (mm) =
 ((Width Ref. + 40) x Nb. Columns) + (2 x 172)

F

+

2

x

G

²If integrated in the centre, add a board to equalise with curve height (ie 3.4)

Half-Frames GSE In-Roof v.2022 - PORTRAIT																				
Height Ref	1650	1650	1650	1650	1650	1650	1650	1840	1840	1840	1840	1840	1840	1840	1840	1840	1840	2030	2030	2030
Width Ref	995	1070	1100	1135	1140	1145	1160	995	1020	1030	1040	1045	1050	1070	1090	1100	1135	995	1050	1055

*Certification of new XXL 2030 Frames currently in process.

3.2.2 Roof cover installation

Remove the roofing elements following the PV array dimensions (calculated beforehand), and by removing 1 or 2 extra tile lines (slate or flat tile) on the lateral sides and top of the array.

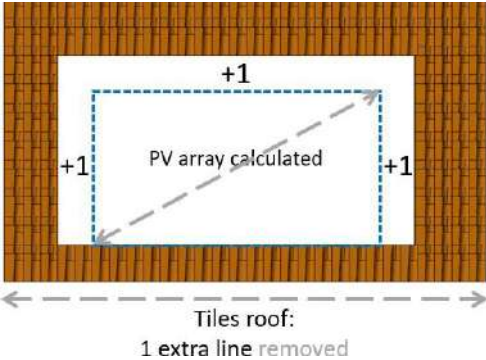
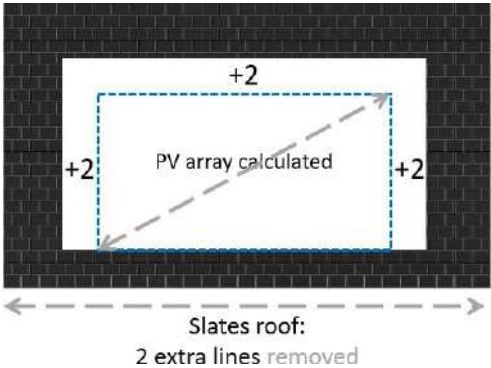

3.3 Positioning of the support battens

WARNING: PRIOR TO STARTING ANY WORK, THE INSTALLER MUST ENSURE THAT THE FRAMEWORK IS FLAT AND THERE MUST BE A ROOF UNDERLAY ACCORDING TO THE BUILDING STANDARD BS 5534.

- 1 Determine beforehand the number of fixing clamps and the adapted batten section (see section 2).
- 2 Dispose the wooden battens to the following locations:
 - 1/ Fixing points of the clamps
 - 2/ Fixing points of the frames
 - 3/ Junction between the frame rows¹
 - 4/ Support of the sealing strip¹
 - 5/ Mounting hooks of top flashings¹

Battens fixing: It is recommended to use self- drilling wood screw of 5x80mm.

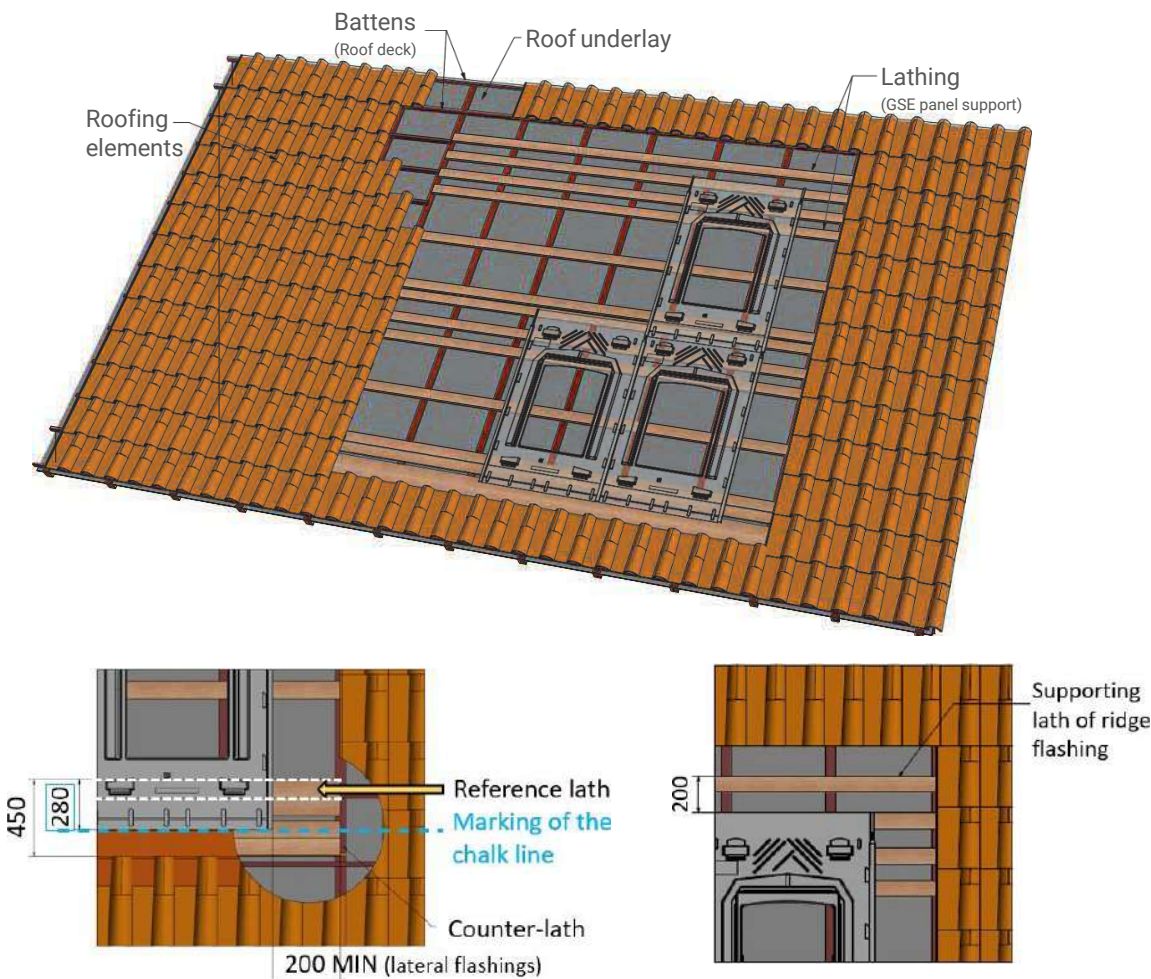

WARNING: THE POSITION OF THE FIXING CLAMPS AND THEIR SUPPORT BATTENS MUST COMPLY WITH MODULE MANUFACTURER REQUIREMENTS.

^[1] Since these elements play no role in the mechanical system strength, the width of the timber could be different from that calculated for the fixing clamps. Only the thickness should be identical.

All of our battening plans in PORTRAIT and LANDSCAPE configuration are available on our site:
<https://www.gseintegration.com/wp-content/uploads/2023/04/GSE-IN-ROOF-SYSTEM-Plans-de-lattage-EN-V3.0.pdf>

BATTENING PLANS FOR PORTRAIT FRAMES WITH A REFERENCE HEIGHT OF 1710 MM
AND 4 FIXING CLAMPS:

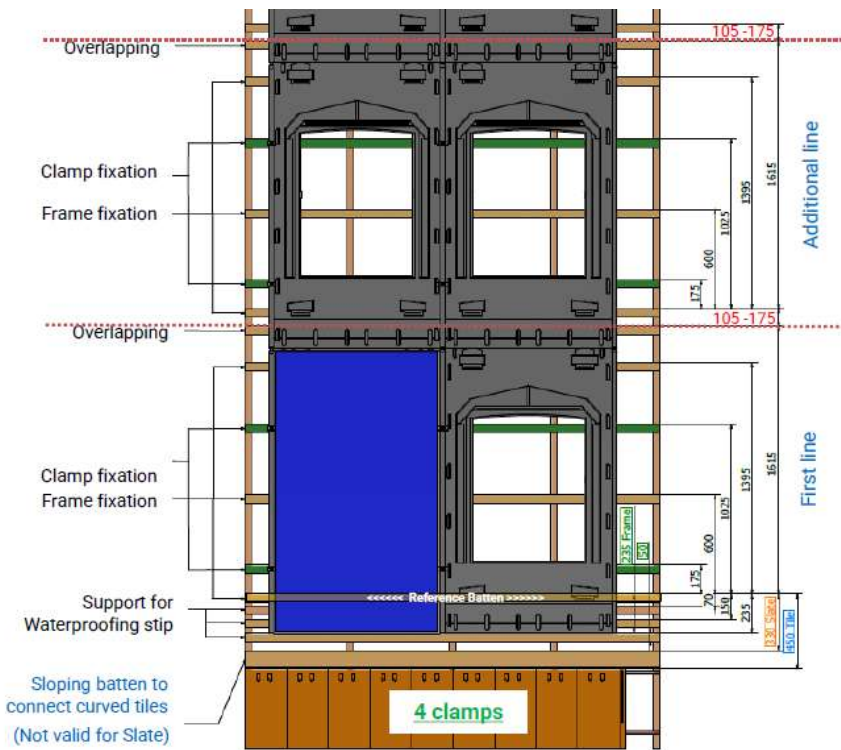

BATTENING PLANS FOR PORTRAIT FRAMES WITH A REFERENCE HEIGHT OF 1710 MM
AND 8 FIXING CLAMPS:

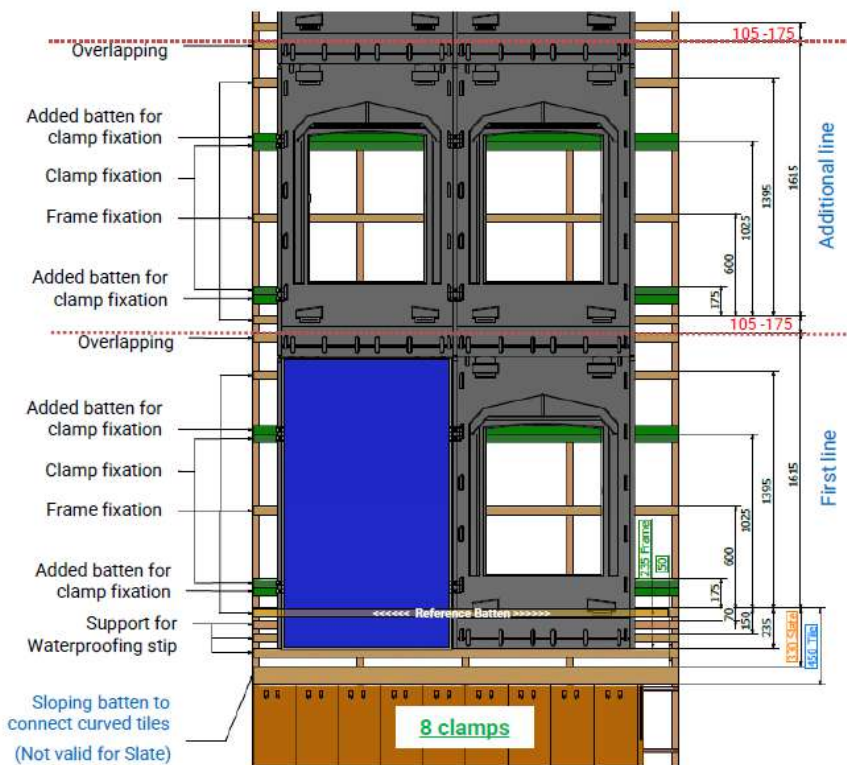

All of our battening plans in PORTRAIT and LANDSCAPE configuration are available on our site:
<https://www.gseintegration.com/wp-content/uploads/2023/04/GSE-IN-ROOF-SYSTEM-Plans-de-lattage-EN-V3.0.pdf>

EXAMPLE OF BATTENING PLANS FOR LANDSCAPE FRAMES WITH A
REFERENCE HEIGHT OF 1020 MM AND 4 FIXING CLAMPS:

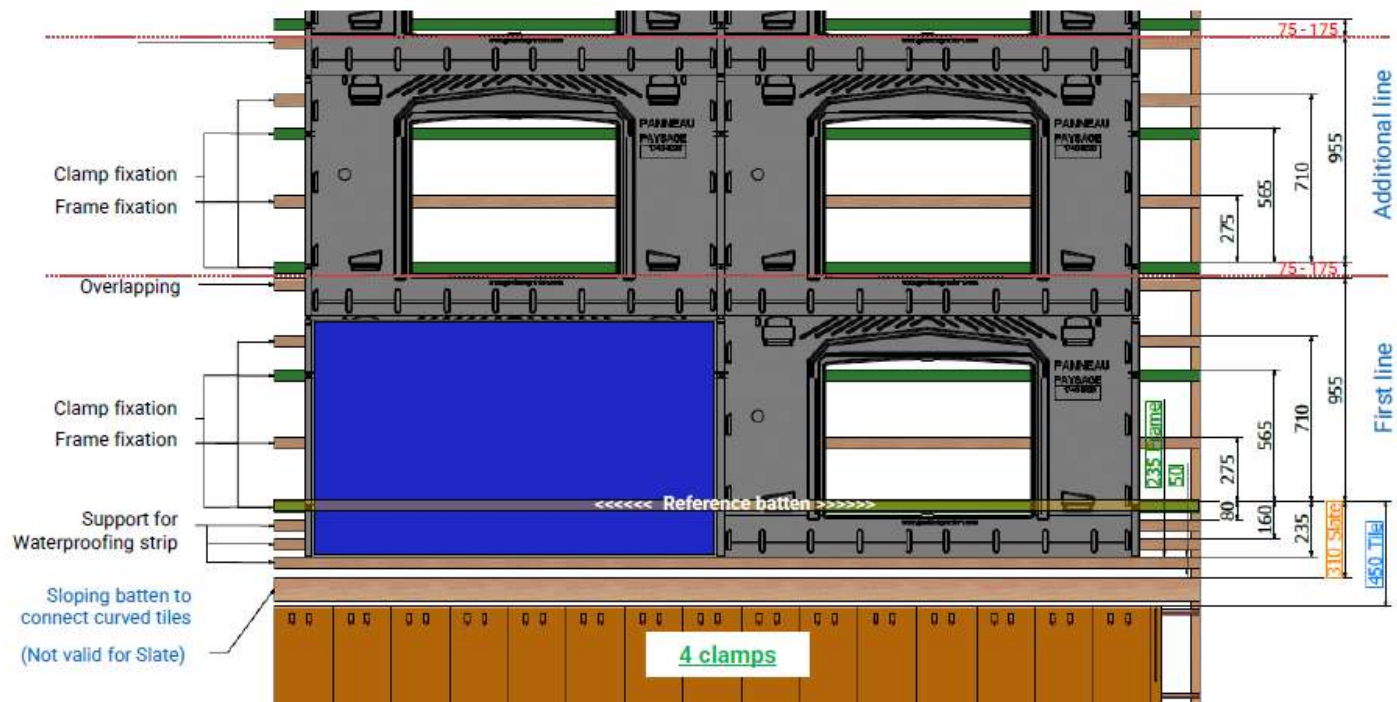

EXAMPLE OF BATTENING PLANS FOR LANDSCAPE FRAMES WITH A
REFERENCE HEIGHT OF 1020 MM AND 8 FIXING CLAMPS:

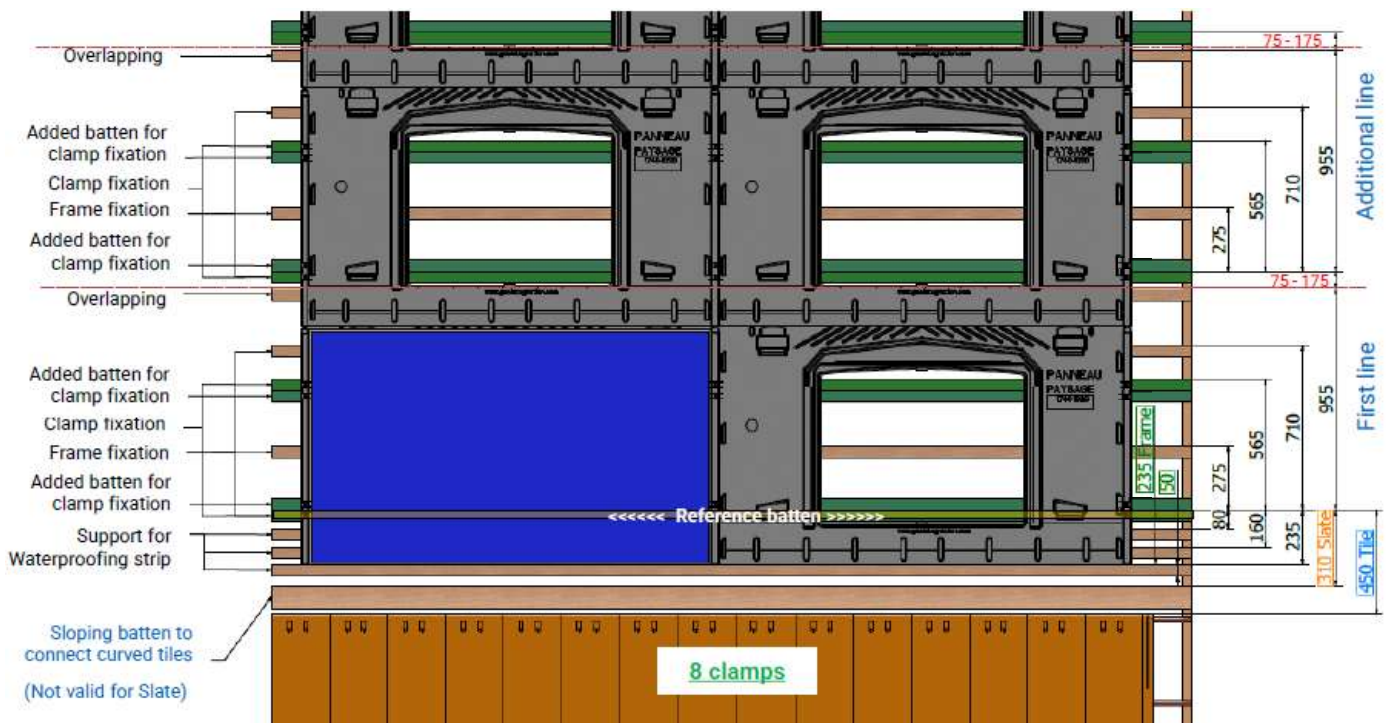

All of our battening plans in PORTRAIT and LANDSCAPE configuration are available on our site:
<https://www.gseintegration.com/wp-content/uploads/2023/04/GSE-IN-ROOF-SYSTEM-Plans-de-lattage-EN-V3.0.pdf>

BATTENING PLANS FOR HALF- PORTRAIT FRAMES WITH A REFERENCE HEIGHT OF 1650 MM AND 4 FIXING CLAMPS:

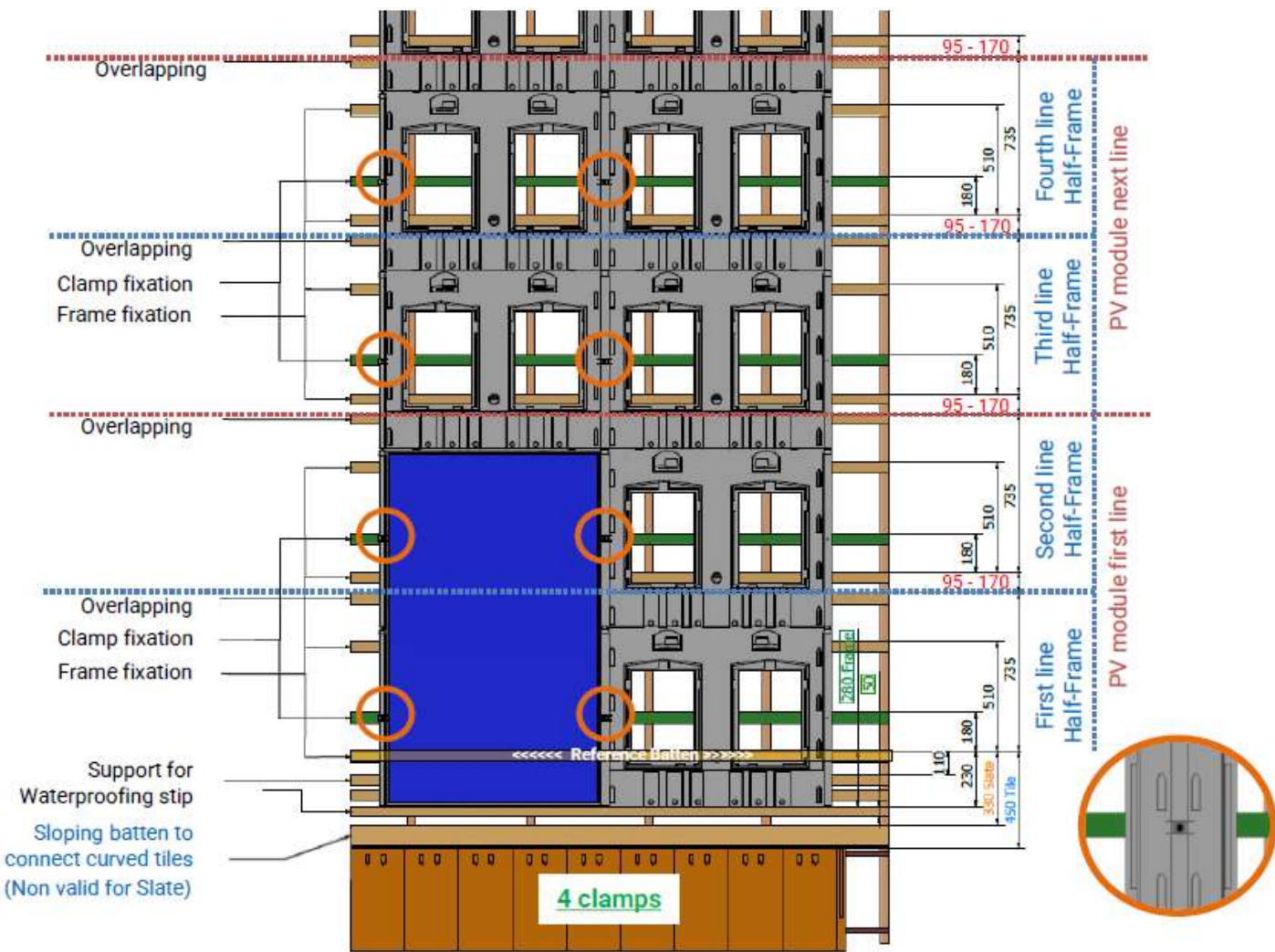

All of our battening plans in PORTRAIT and LANDSCAPE configuration are available on our site:
<https://www.gseintegration.com/wp-content/uploads/2023/04/GSE-IN-ROOF-SYSTEM-Plans-de-lattage-EN-V3.0.pdf>

BATTENING PLANS FOR HALF- PORTRAIT FRAMES WITH A REFERENCE
HEIGHT OF 1650 MM AND 8 FIXING CLAMPS:

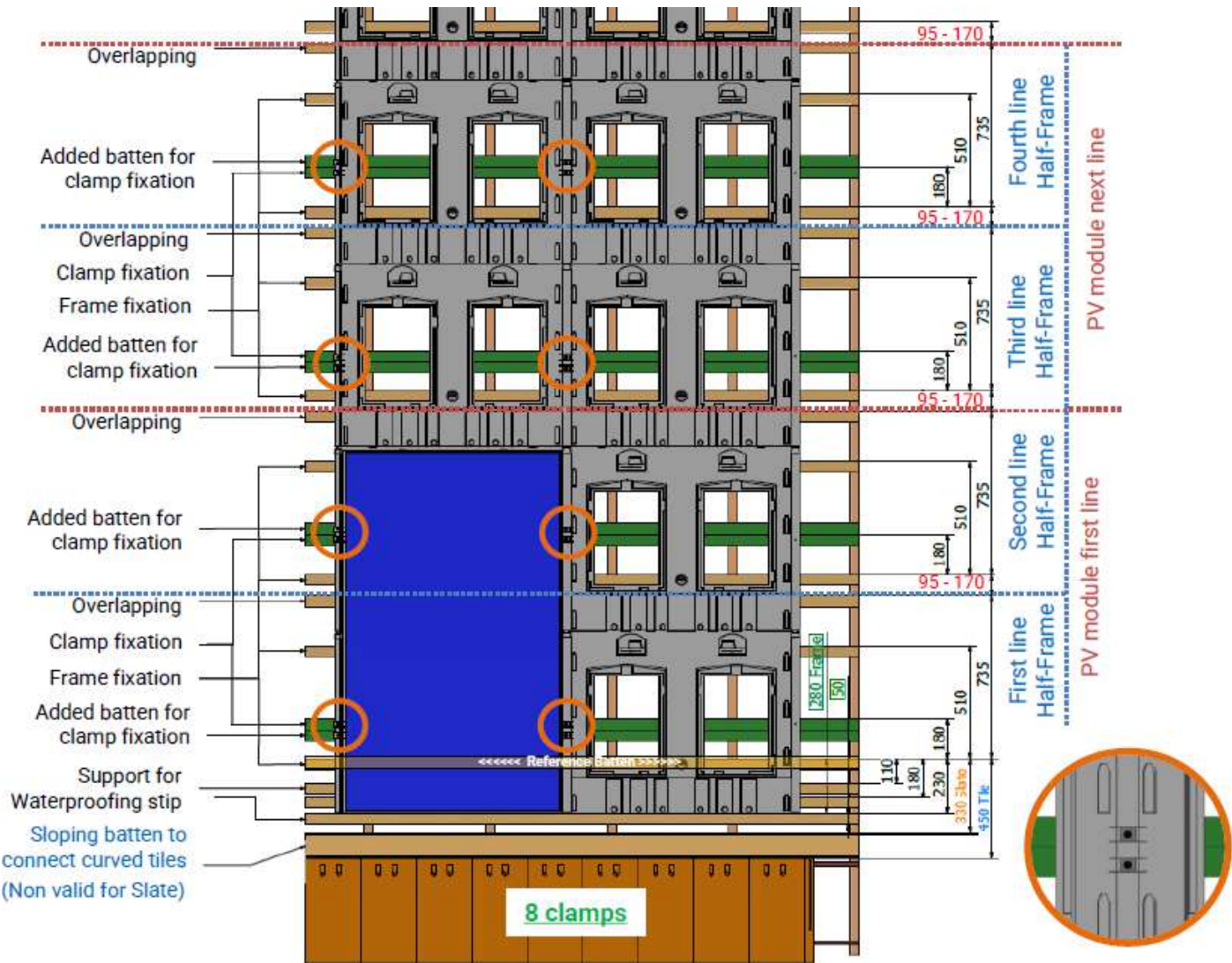

3.4 Sealing strip installation

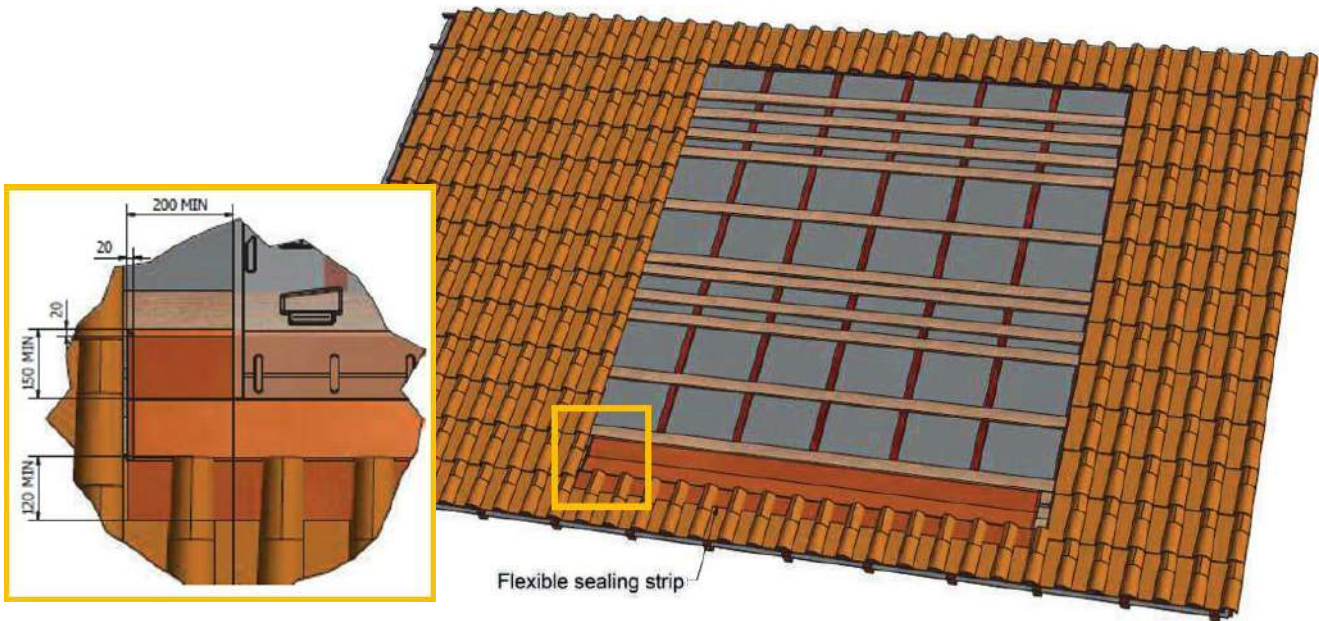

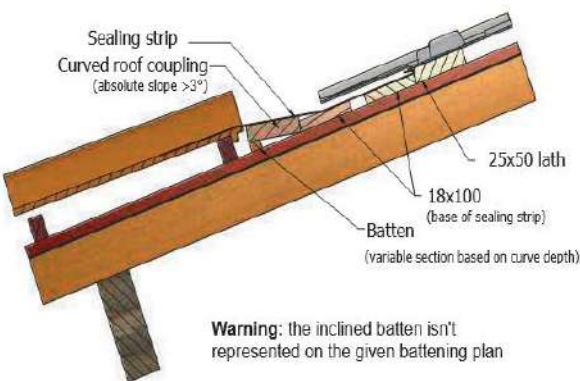

The sealing strip is laid out to link up with the bottom part of the roofing (PV array in the middle of the roofing).

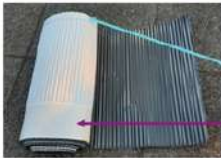

A batten is placed to fit with the thickness of the roof tile and to provide a flat base for the sealing strip.

WARNING : ALWAYS MAINTAIN A MINIMUM SLOPE OF 3°



 **Warning:** lay the waterproofing strip right side up

TOP: The butyl strip of 2cm is laid under the GSE frames

BOTTOM: The butyl strip of 10cm is laid on the tiles

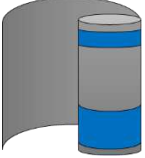

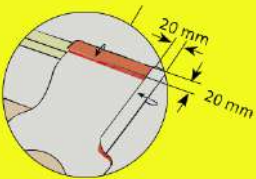

When installing the sealing strip on tiles with relief, make sure to press it down well so that it follows the roof tile's shape correctly. Make a 20-mm fold on the top part and sides to prevent water upwelling. Put spots of glue every 50cm when installing in heavy rain / high wind areas.

When installing all the way to the eaves, the sealing strip is laid out in a way as to connect directly to the gutter.

The connection of the waterproofing strip to the gutter can be done with a drip flashing: one for the PV field, another one for the roof underlayment.

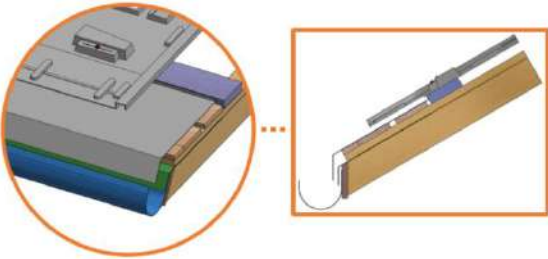
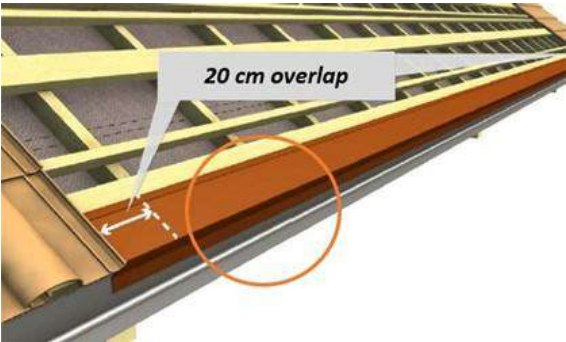

3.5 GSE Frames Installation

A

Frames v.2012 and v.2020

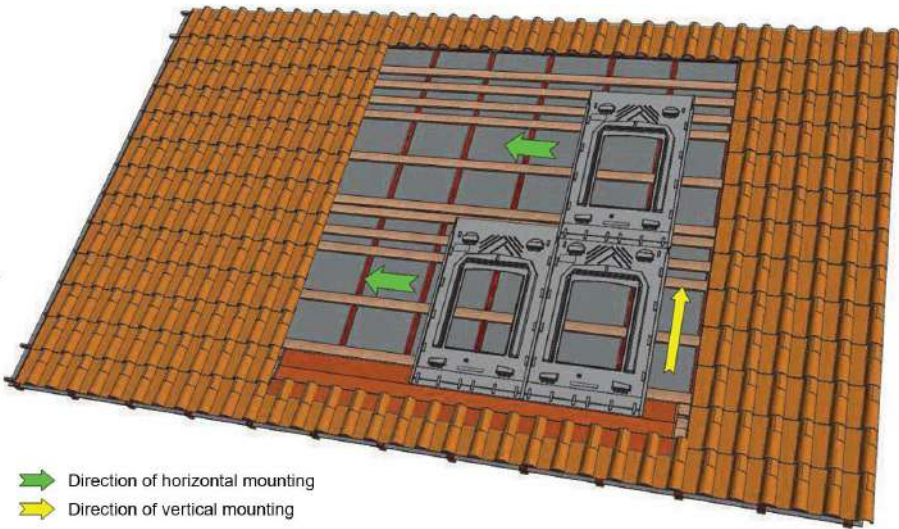

➡ Direction of horizontal mounting
➡ Direction of vertical mounting

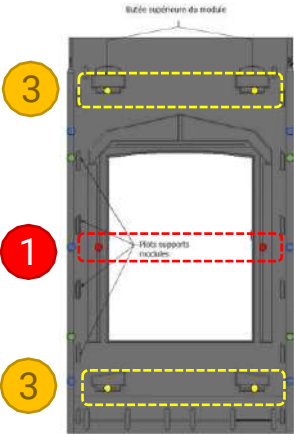

- 1 Fix the 1st frame through the 2 central fixing points
- 2 Assemble and fix the other frames
- 3 Pre-drill and fix the 4 other fixing points

- Plate fixing point (without pre-drilling)
- Plate fixing point (pre-drilling 10mm)
- Clamp fixing point (6 clamps) (pre-drilling 10mm)
- Clamp fixing point (4 clamps) (pre-drilling 10mm)

 **Warning: Do not screw too deep into the frame**



B

Half-Frames v.2022

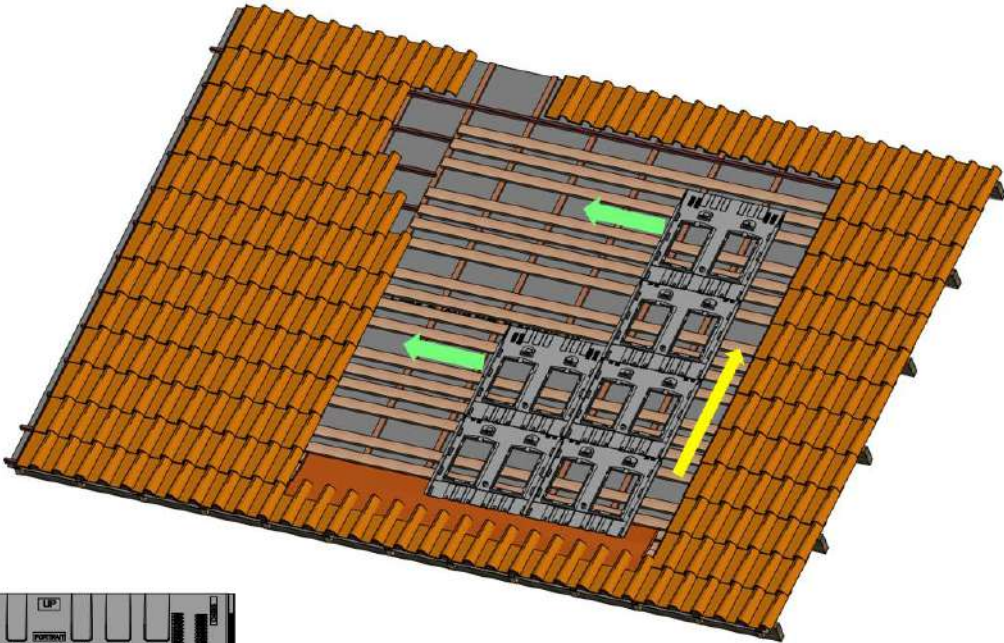

- ➡ Direction of horizontal mounting
➡ Direction of vertical mounting

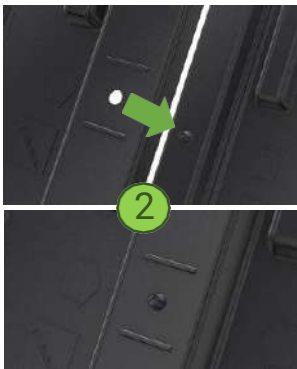
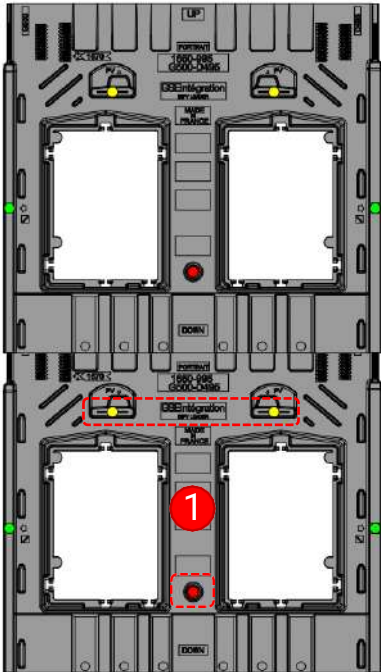

- 1 Fix the 1st half-frame through its middle fixation point and through the 2 other fixation points on the upper plot **already** pre-drilled.
- 2 Assemble the other half-frames laterally thanks to the stop and vertically. Fix them the same way than described in 1.

- Plate fixing point (**already placed, without pre-drilling**)
- Plate fixing point (**already pre-drilled at 10mm**)
- Plate fixing point (4 clamps) (**lateral interlocking needing a 10 mm pre-drilling**)

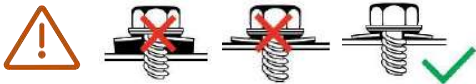

Warning: Do not screw too deep into the frame

WARNING: THE SCREW LENGTH CAN BE REDUCED TO 40MM AT THE FRAME FIXING POINTS IF AND ONLY IF THE ROOF-SUBSTRUCTURE INSTALLATION DOES NOT INCLUDE COUNTER-BATTENS. OTHERWISE, USE ONLY THE GSE STANDARD 60MM SCREW WITH ITS IN-ROOF SYSTEM.

1 Draw a chalk line along the bottom of the first row, by positioning 280 mm from the top of the reference lath.

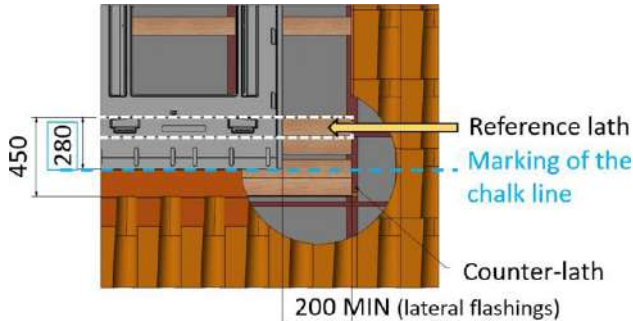

2 Interlock the plastic frames from the right to the left side (Possibility from left to right - check interlocking is well done).

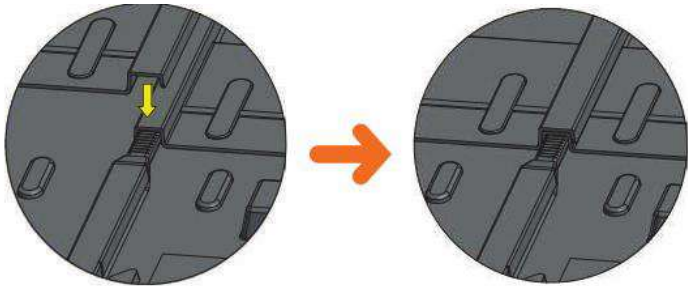

3 Attach the frames only by the reference points.

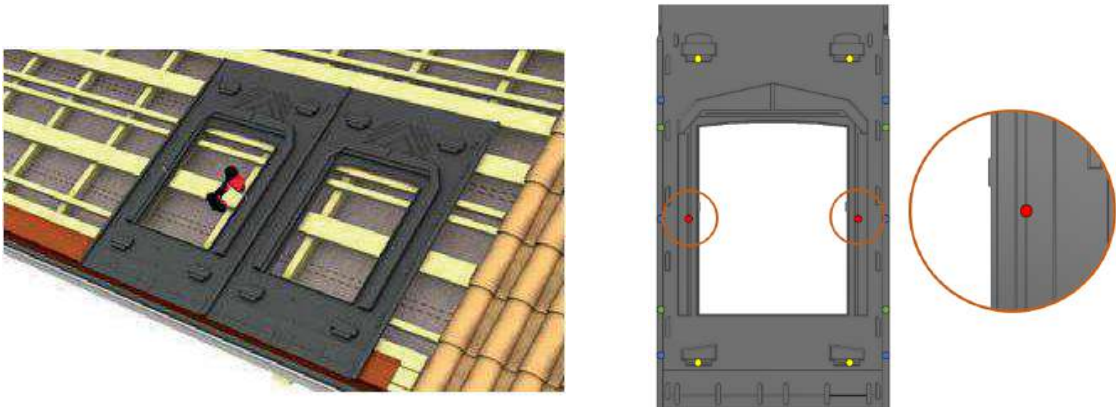

WARNING: WHEN INSTALLING THE UPPER ROWS, ADJUST SO THAT ONE ROW COVERS THE OTHER USING THE GRADUATIONS BASED ON THE LENGTH OF THE MODULE (IE DEVICE).

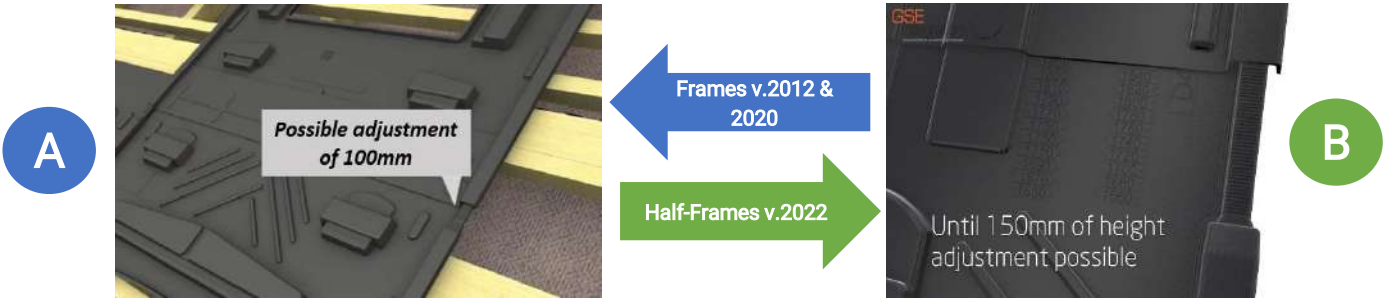

3.6 Lateral flashings installation

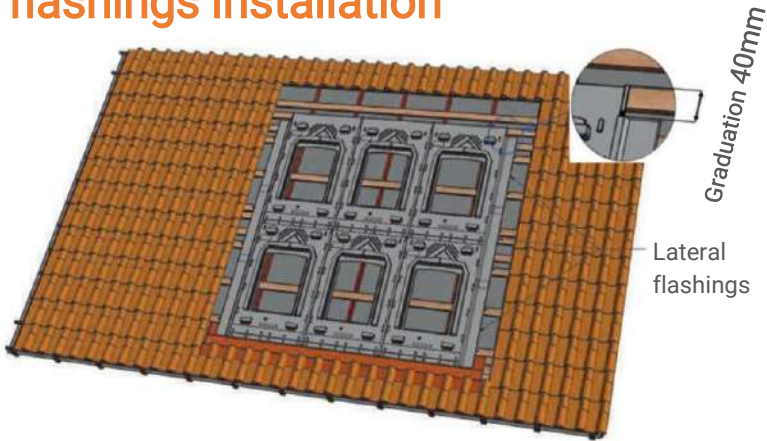

WARNING: BEFORE INSTALLING THE LATERAL FLASHINGS, MAKE SURE TO PLACE THE WEDGES AT THE ARRAY ENDS, UNDER THE CORRUGATIONS, WHERE THE END CLAMPS ARE LOCATED.

- 1 Place the wedges under the corrugations at the edges of the PV field, where the clamps are located

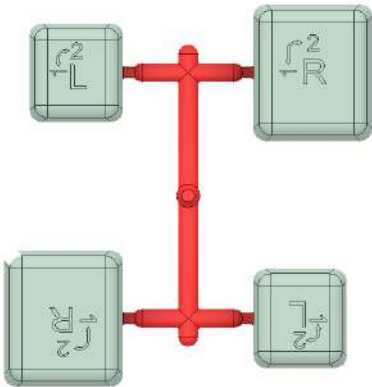

R for the Right side of the PV array.

L for the Left side of the PV array.

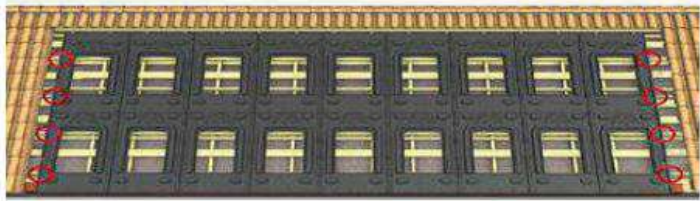

TIP: Mark their position on the inner surface of the frame to identify them after positioning the lateral flashings.

Position 1: wedges for Half-Frames v.2022.

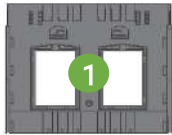
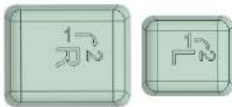

Position 2: wedges for Frames v.2012 and v.2020.

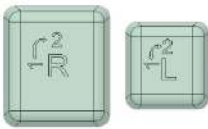

- 2 Place the lateral flashings of the low end of the first row of panels, up to 120 mm of the upper edge of the last row. The overlap between two parts of the lateral flashing will be at least 150 mm. Each will be held in place by at least 2 attachment hooks.

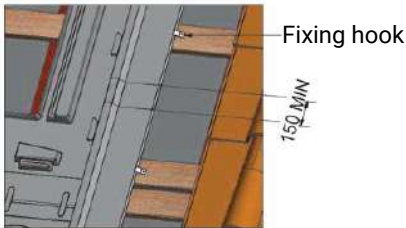

WARNING: FOR THE 2022 HALF-FRAMES, CUT THE ERGOT BEFORE PUTTING THE LATERAL FLASHINGS ON THE FRAMES' CORRUGATIONS



3 Carry out the pre-drilling using a 10 mm wooden drill bit on the 4 remaining attachment points of the GSE frame (Half-Portrait frames v.2022 are already pre-drilled)

TIP: It is possible to pre-drill the expanding points of the frame before mounting on the roof. The frames are drilled individually (do not drill several frames at the same time).

Pre-drill

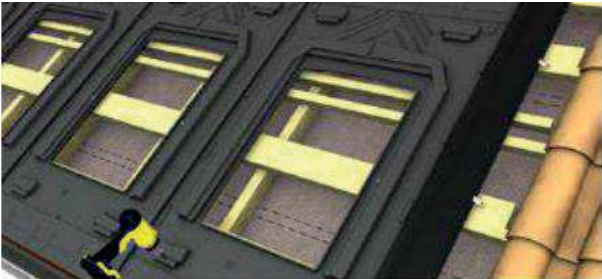

Screw

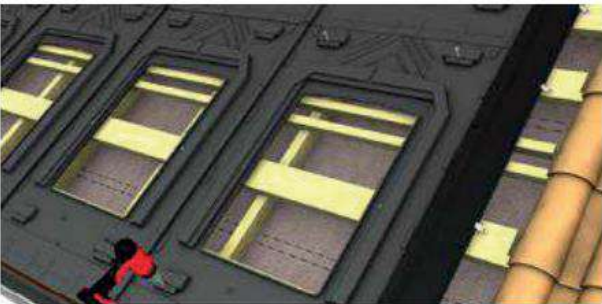

4 Then, pre-drill the fixing points of the clamps.



5 For end clamps, pre-drill through the flashing, the frame's corrugation and the wedges.



Reminder : It is prohibited to drill in the outflow zones and at the high points of the GSE frame. It may compromise the integrity of the photovoltaic system and its watertightness.

Please refer to the plans pages 7, 8 and 9 for the location of the fixing points.

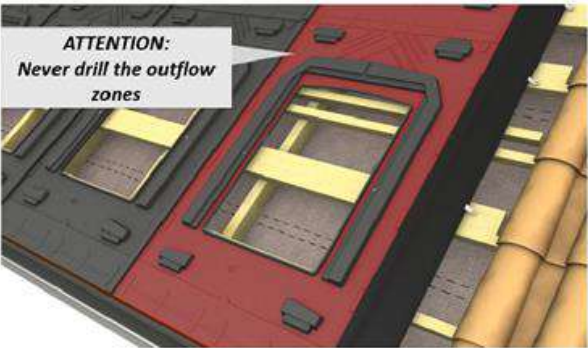

3.7 PV modules installation

3.7.1 Cabling preparation

EXAMPLE OF WIRING DIAGRAM WITH INSTALLATION OF MICRO-INVERTERS:

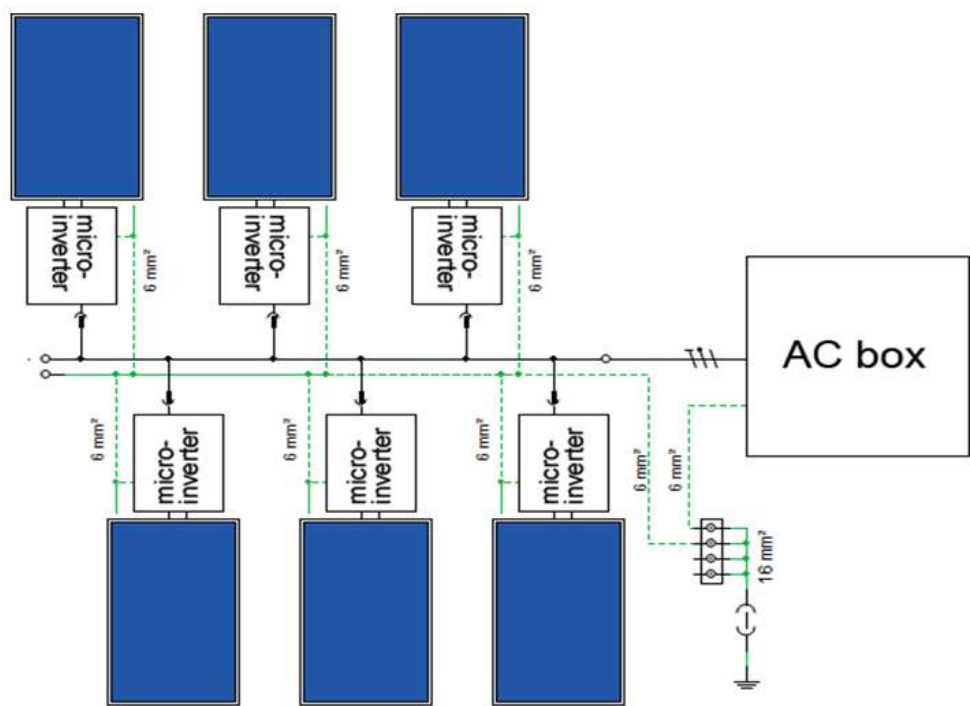

Position the module in such a way that the cables of the junction box pass through the designated space.

TIP: Some module manufacturers allow portrait orientation setting with the junction box going downwards. Please refer to the manufacturer’s guidance.



Modules with split junction box are only compatible with the 2020 frames and 2022 half-frames.

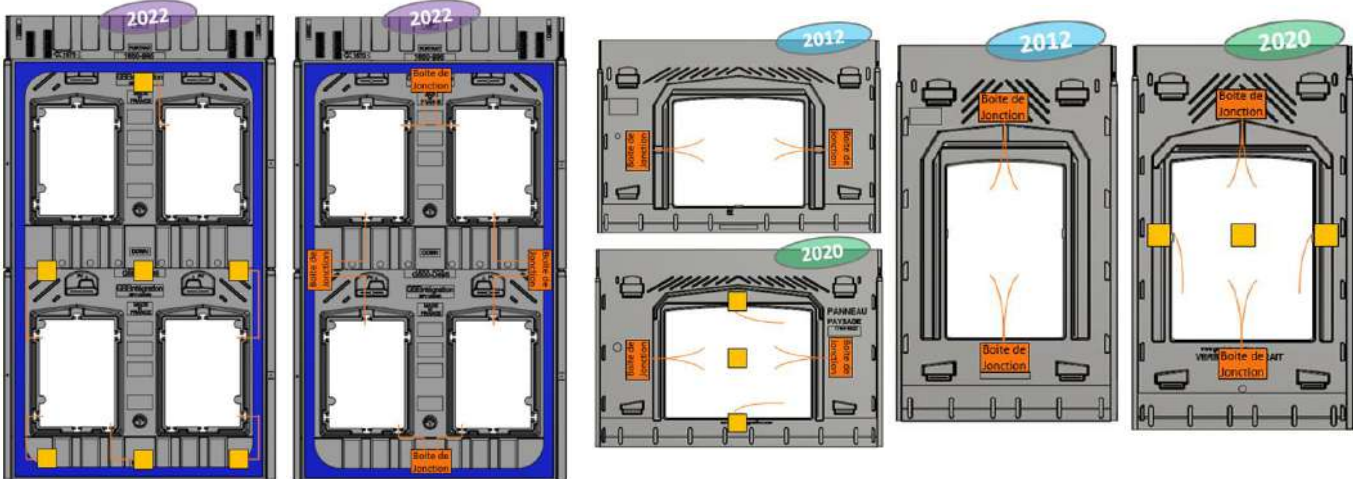

When using micro-inverters, attach them to a lath at the level of the GSE frame's central hole.

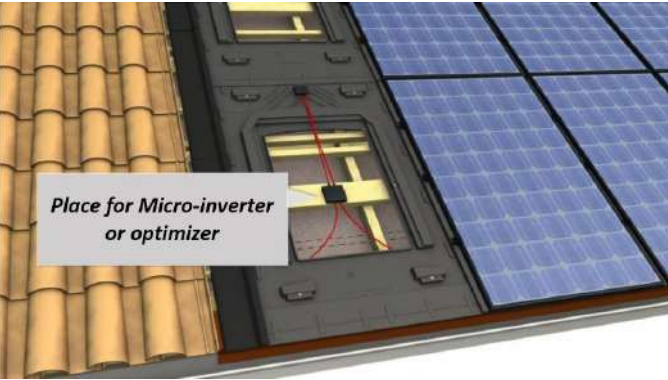

WARNING: PLEASE REFER TO THE INVERTER'S MANUAL TO BE SURE THAT THE INSTALLATION COMPLY WHY THE MANUFACTURER RECOMMENDATIONS

✓ Compatibility with all micro-inverters and optimizers on the market

Passage of the grounding cables:

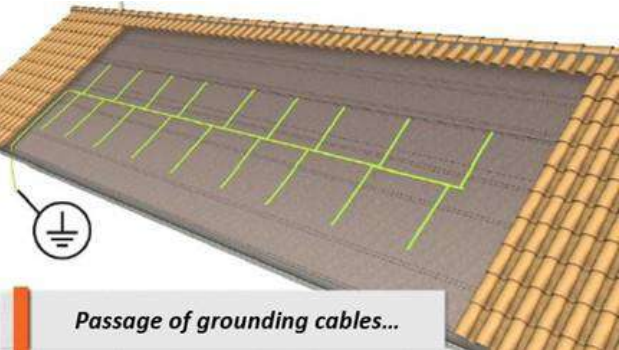

WARNING: WHEN SETTING UP THE CABLES, MAKE SURE YOU DO NOT CREATE ANY INDUCTION LOOP, IN ACCORDANCE WITH REGULATION.

Grounding of the modules and of the micro-inverter (please refer to the implementation requirements of manufacturers):

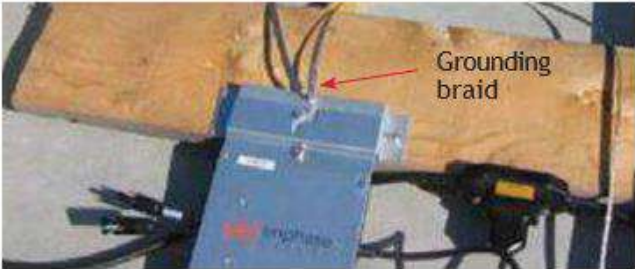
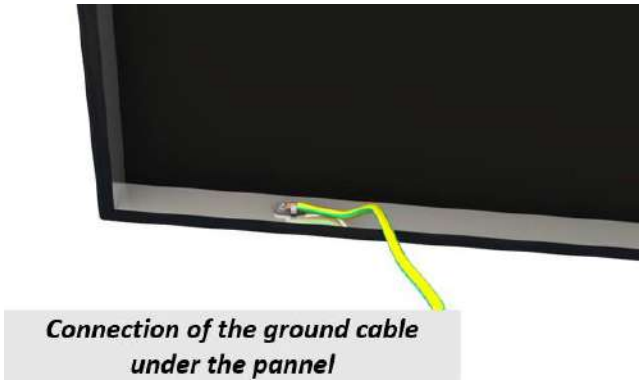

WARNING: MAKE SURE THAT ALL CABLE PASSAGES ARE KEPT ON THE FRAME USING CABLE CLAMPS.

3.7.2 Modules mounting

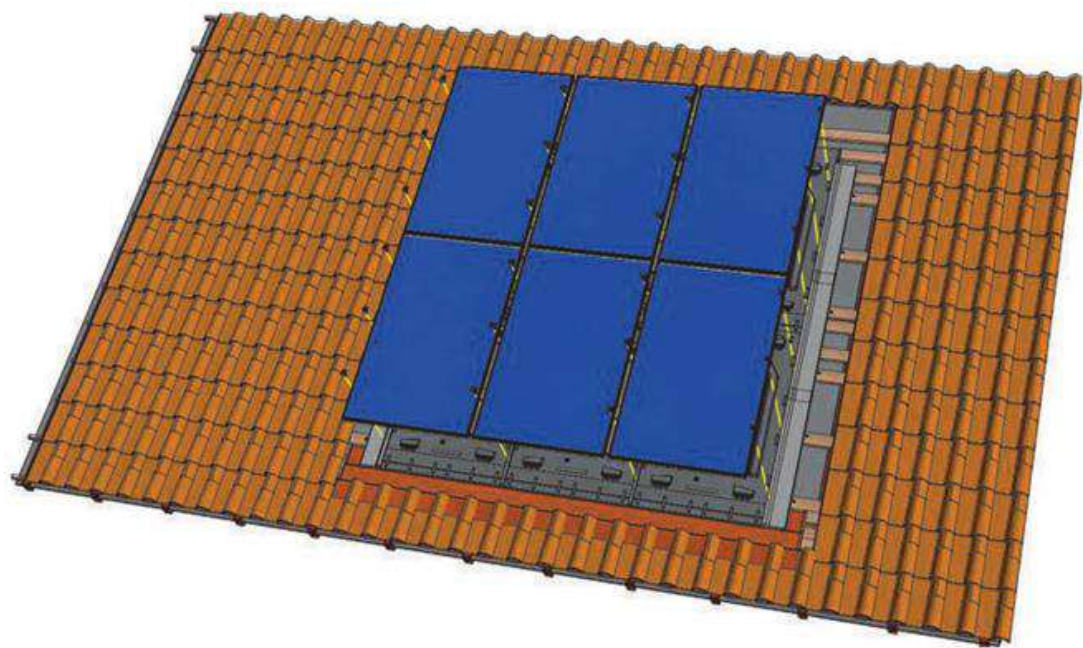

- 1 Position the modules in such a way that they are resting on the support pads and abut against the upper pads (orange arrows).

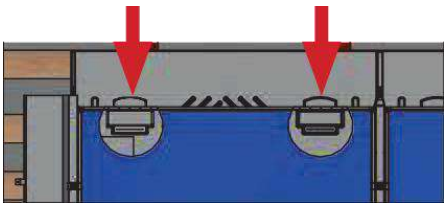
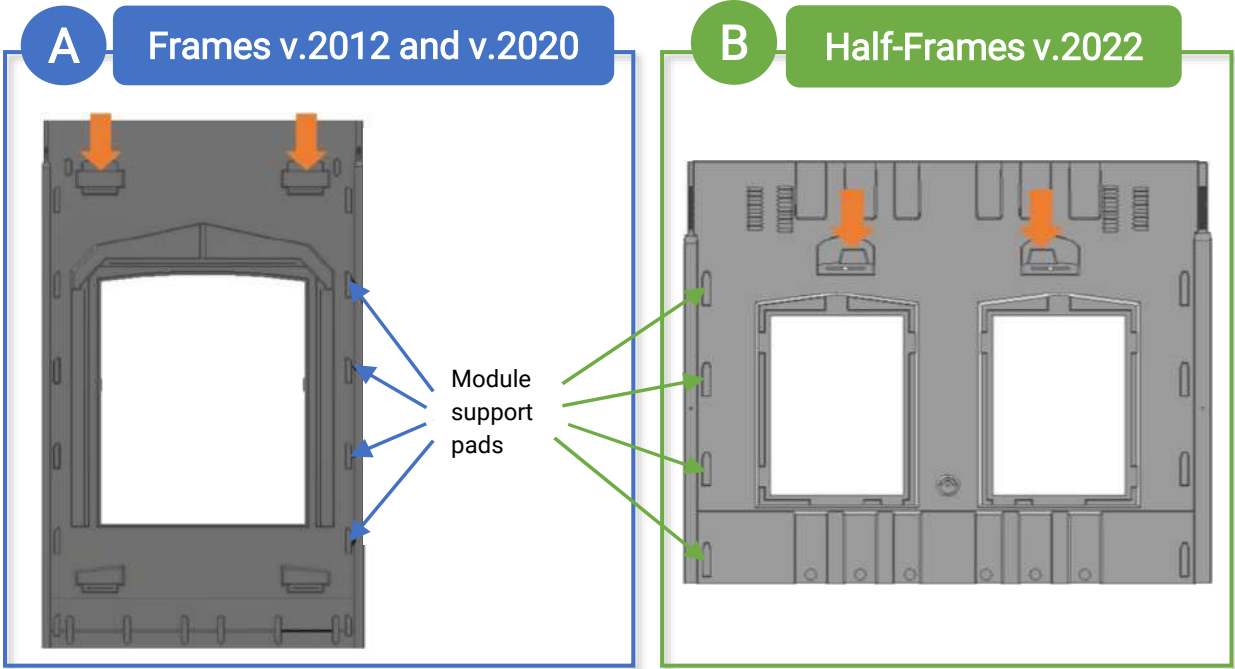

WARNING: CHECK THAT THE MODULES ARE WELL CENTERED IN RELATION TO THE FRAME SO THAT THE GRIP OF THE CLAMPS IS THE SAME ON BOTH SIDES. THE MODULE FRAME MUST ABUT AGAINST THE UPPER PADS OF THE PANEL TO PREVENT SHIFTING.

- 2 Pre-drill with a 10mm drill bit the position/fixing points of the clamps on the GSE In-Roof Frame.

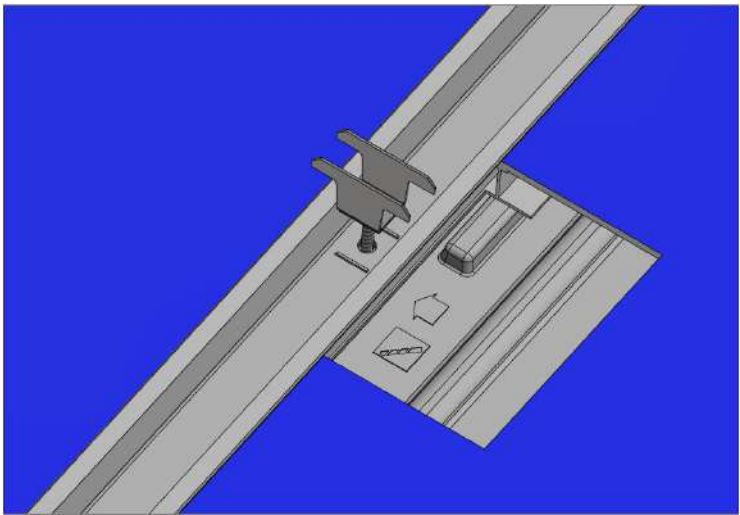
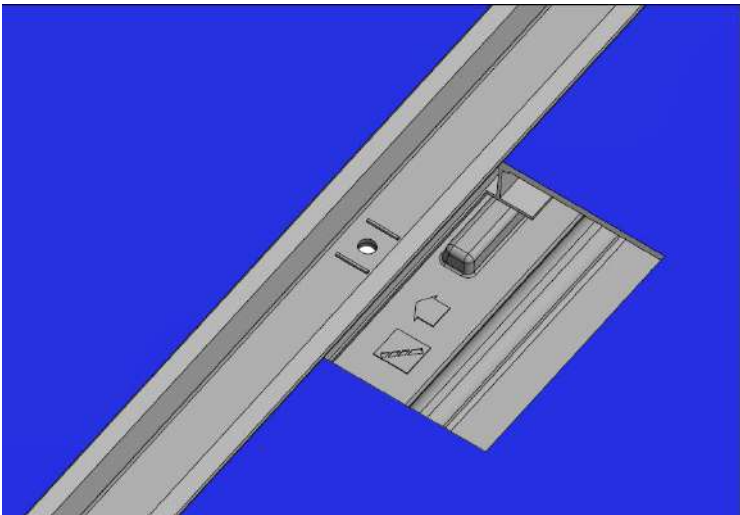
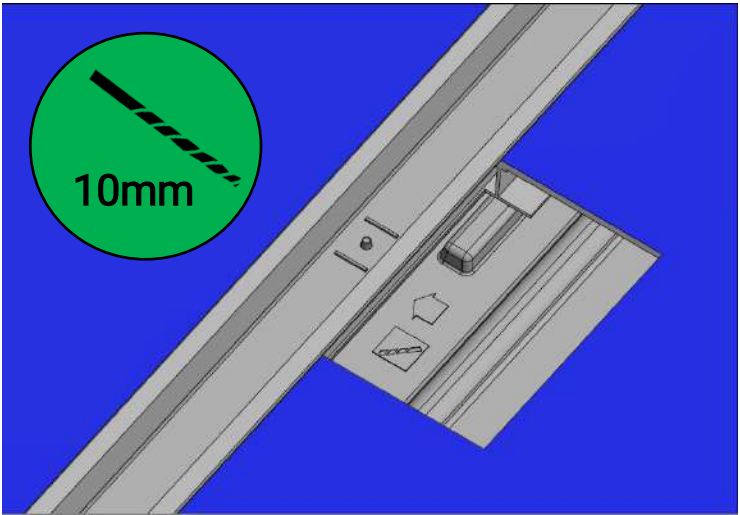

Half-Portrait v.2022

- 3 Attach the modules by screwing the fixing clamps at the designated positions.

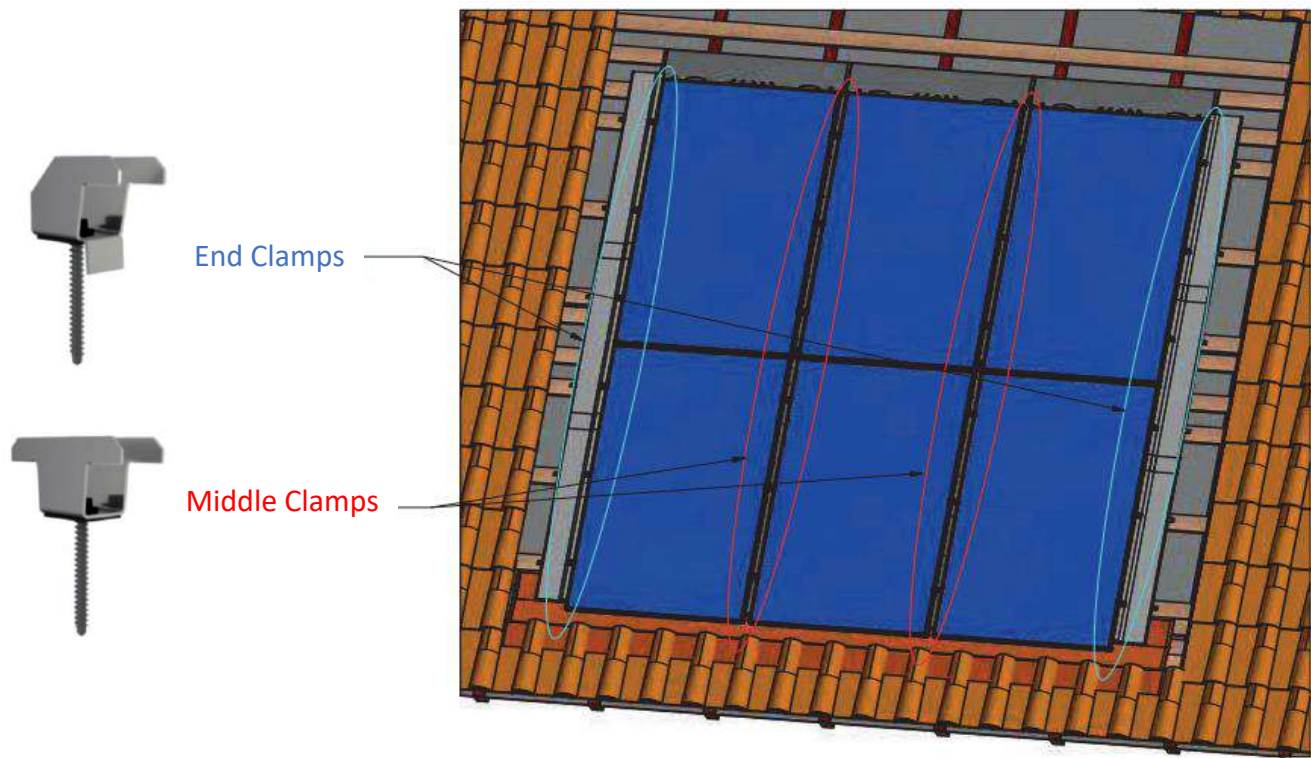

DO NOT USE AN IMPACT SCREWDRIVER TO FIX THE CLAMPS. IT IS NECESSARY TO USE A NORMAL SCREWDRIVER TO ENSURE THAT THE CLAMPS REMAIN MECHANICALLY STILL OVER TIME.

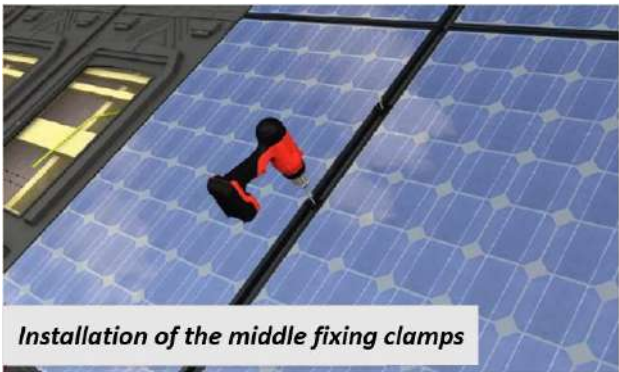

3.8 Top flashing installation

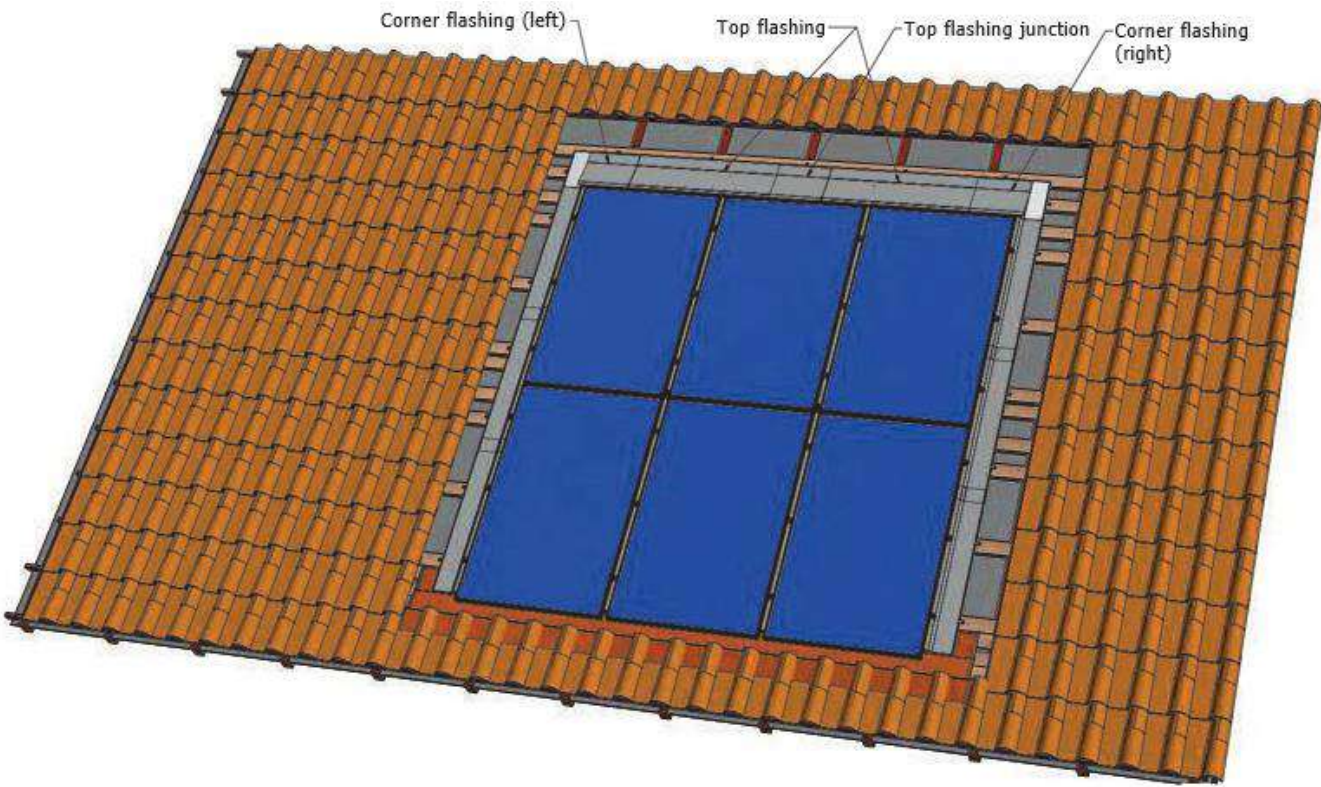

WARNING: THE TOP FLASHING PIECE IS DESIGNED WITH A SLOPE OF 14° TO ALLOW WATER FLOW ABOVE THE UPPER ROW OF MODULES. IT IS THEREFORE, ESSENTIAL FOR THE INSTALLER TO ENSURE THAT THE ROOF SLOPE IS SUFFICIENT TO PREVENT WATER RETENTION ACCORDING TO THE REGULATION.

IN BORDERLINE CASES, WE RECOMMEND THAT YOU EITHER USE A THICKER SUPPORT LATH TO DECREASE THE COUNTER-SLOPE OR TO REPLACE THE TOP FLASHINGS WITH A FLEXIBLE FLASHING STRIP (SEE PAGE 34).

- 1 Join the top flashings and the attach angle using pop rivets, taking care that you adjust the module frame thickness.



Pop riveting



- 2 Position the assembly so that the module frame thickness fits between the attach angle and the top flashing.



Perfect ajustement of the assembly

Make cuts on the attach angle at the position of the GSE panel corrugations.



Cut on the attach angle

- 3 Place the top junction flashing, having applied beforehand two PU glue joints on the covered top flashing area. The connecting piece must overlap with the top flashing with at least 100 mm. The gap between the top flashings should not exceed 160 mm.

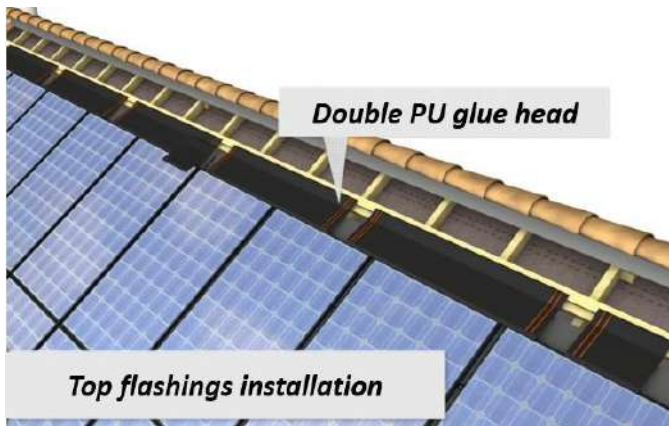

Top flashings installation

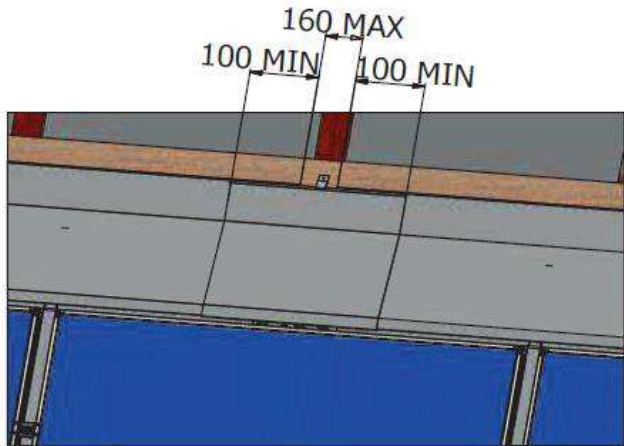

- 4 In the same way, place the corner flashings, having applied beforehand a PU glue joint on the overlapping zone of the top flashing. (Overlapping at least 100mm)

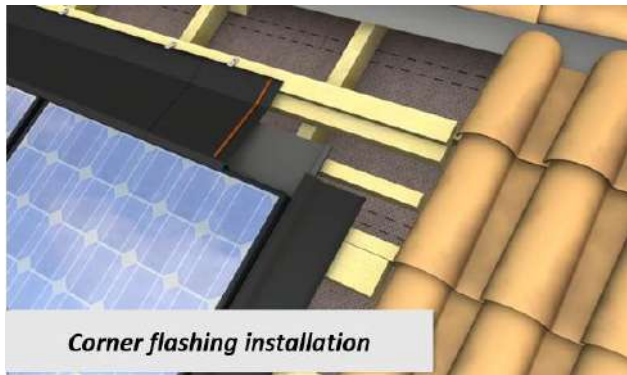

Corner flashing installation

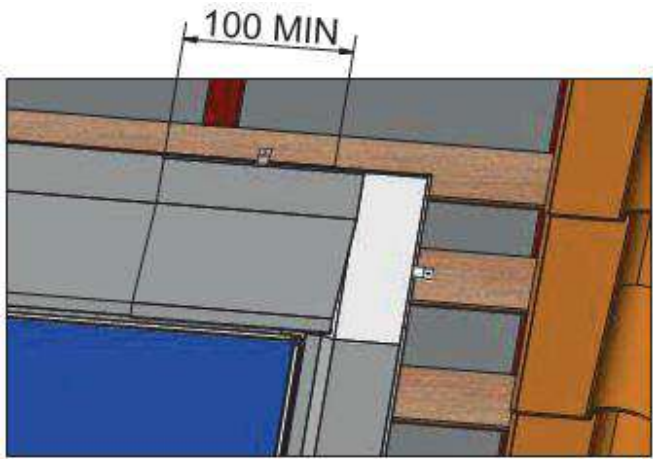



SPECIFIC CASE: if a gap is observed between the module and the corner flashing, cut it in order to adapt it to the thickness of the module.

Module thickness	30-34 mm	30-39 mm	40 and +
Frames 2012	Incompatible*	Needed cut	No cut needed
Frames 2020	Needed cut	No cut needed	Incompatible*
Half-frames 2022	Needed cut	No cut needed	Incompatible*

* Laying of a waterproofing strip on top of the PV field

GSE frames - PORTRAIT																		
	Frames v.2012								Frames v.2020									
Height Ref	1580	1575	1575	1575	1640	1640	1686	1710	1710	1710	1710	1710	1710	1710	1710	1710	1710	1710
Width Ref	808	1046	1053	1082	992	1001	1016	995	1000	1005	1010	1020	1025	1030	1040	1045	1050	1055

GSE frames - LANDSCAPE																				
	Frames v.2012											Frames v.2020								
Height Ref	1082	1082	808	992	992	992	992	992	992	992*	992*	1020	1020	1020	1020	1020	1020	1020	1020	1020
Width Ref	1559	1575	1580	1640	1650	1660	1670	1675	1680	1686	1700	1665	1675	1680	1685	1690	1695	1700	1705	1740

Half-Frames GSE In-Roof v.2022 - PORTRAIT																				
Height Ref	1650	1650	1650	1650	1650	1650	1650	1840	1840	1840	1840	1840	1840	1840	1840	1840	2030	2030	2030	2030
Width Ref	995	1070	1100	1135	1140	1145	1160	995	1020	1030	1040	1045	1050	1070	1090	1100	1135	995	1050	1055

*Certification of new XXL 2030 Frames currently in process.

Follow the 4 steps below to cut the corner flashings

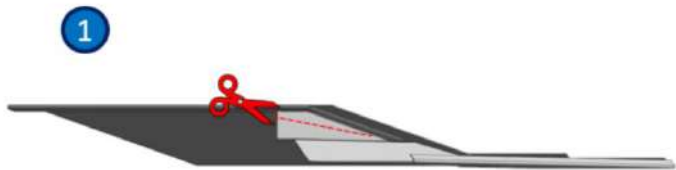

Cut the corner flashing in two distinct pieces

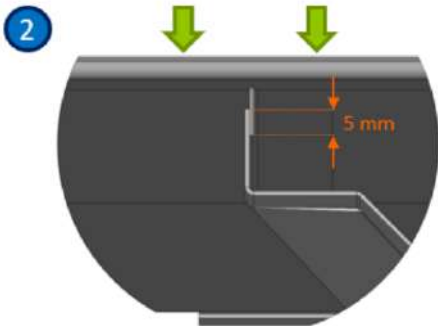

Adjust the height of the corner flashing by overlapping the two pieces

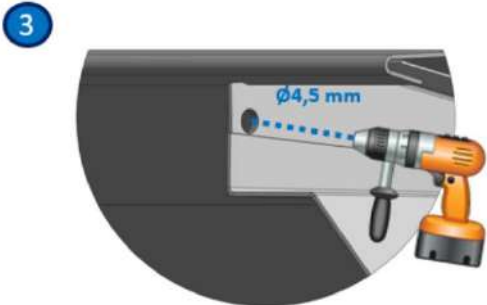

Once the height adjusted, drill the overlapped pieces with a 4,5mm drill bit

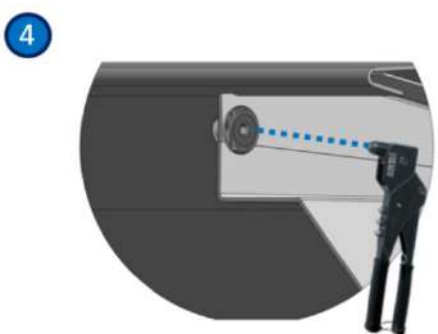

Assemble the pieces with a rivet

Once the adjustment of both corner flashings is done, install them as described in step 4, page 31.

- 5 Fix all flashings to the battens using flashing hooks (at least 2 per piece).

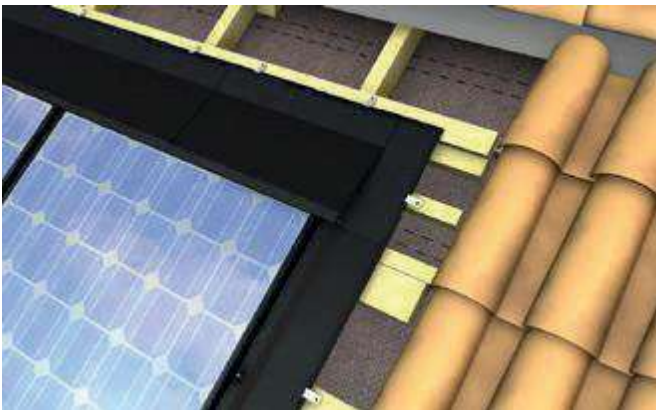
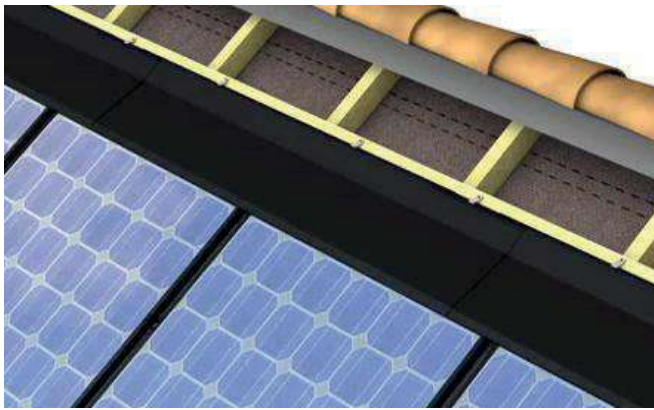

- 6 Place the precompressed seal on the flashings around the area on the lateral and upper parts.

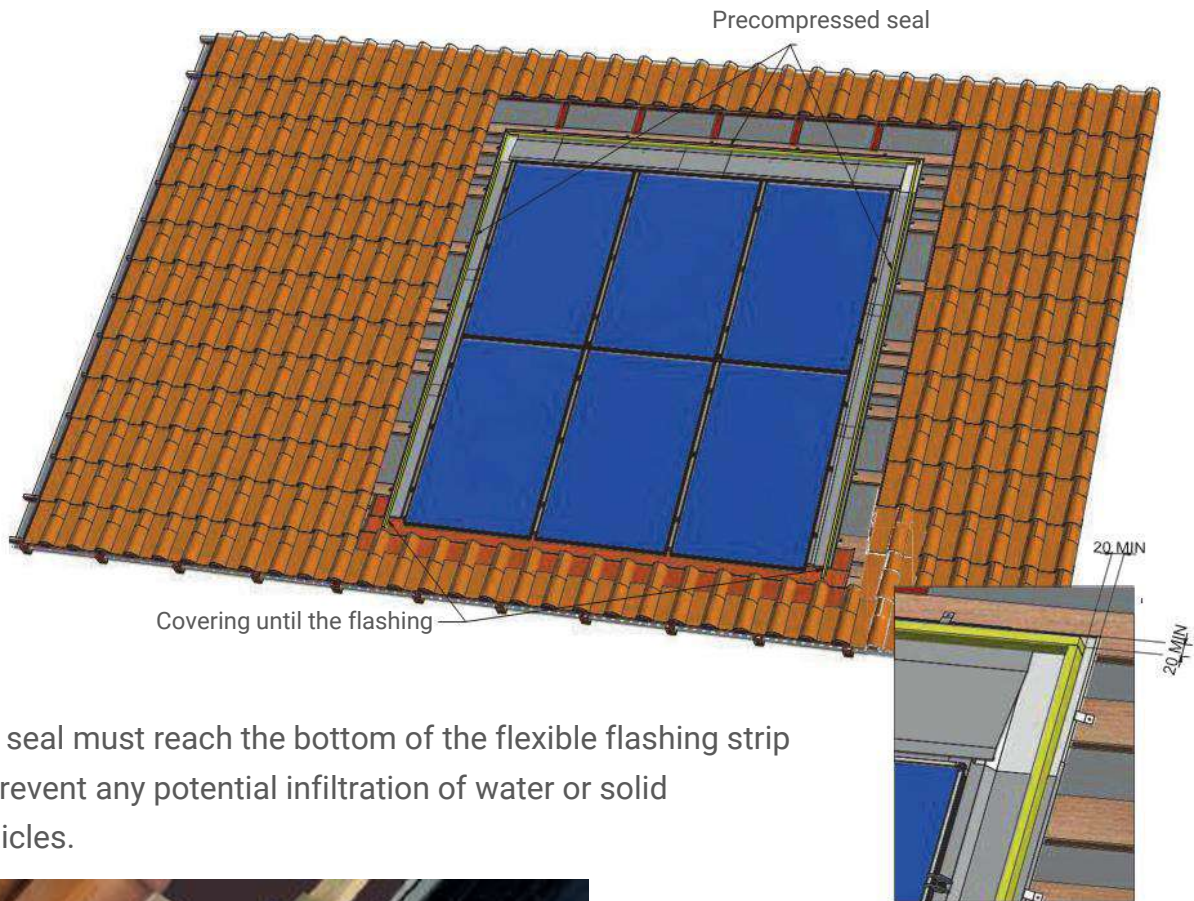

The seal must reach the bottom of the flexible flashing strip to prevent any potential infiltration of water or solid particles.

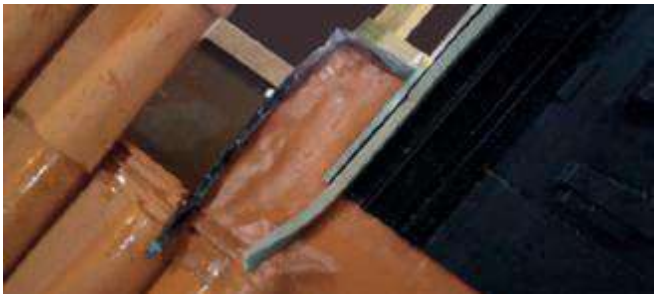

OPTION: REPLACING TOP FLASHINGS WITH A FLEXIBLE STRIP

It is possible to install a flexible flashing strip or equivalent to make the connection with the upper roofing elements. Shape a 2-cm fold in the upper and lateral parts of the strip to prevent any water upwelling.

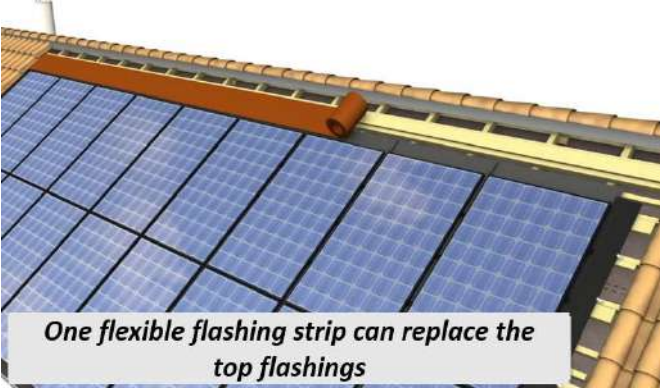

3.9 Specific case: PV array inner/outer angles

In the case of non-rectangular PV array, inner and outer angles must be connected to the roofing using a flexible flashing strip compliant with the building/roofing regulation.

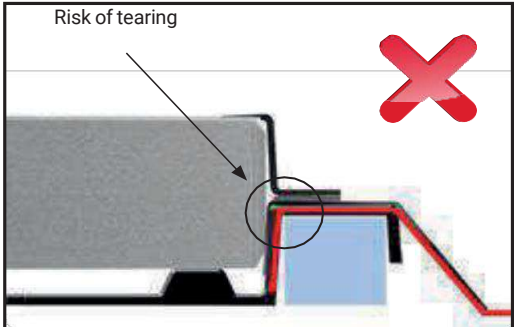
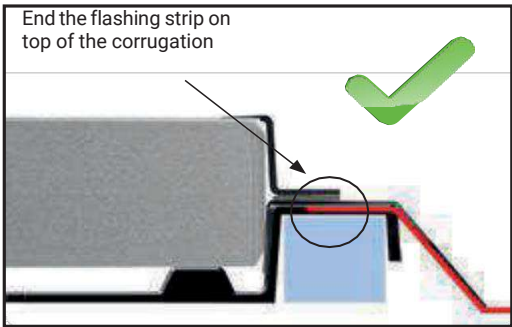
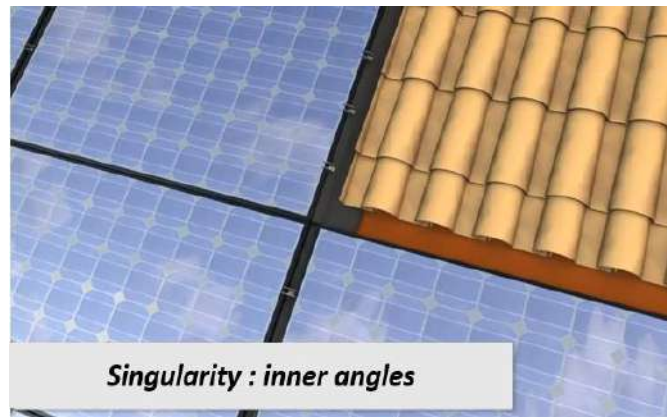

WARNING: IN BOTH CASES, THE FLEXIBLE STRIP CAUGHT BETWEEN THE FLASHING AND THE CORRUGATION OF THE GSE PANEL MUST BE POSITIONED ON TOP OF THE CORRUGATION TO PREVENT THE RISK OF TEARING.

3.9.1 Inner Angle (L-Shaped)

Place the flashing strip by covering the lower-row frames up to the corrugation of the adjacent frame, then cover the strip with the lateral flashing.

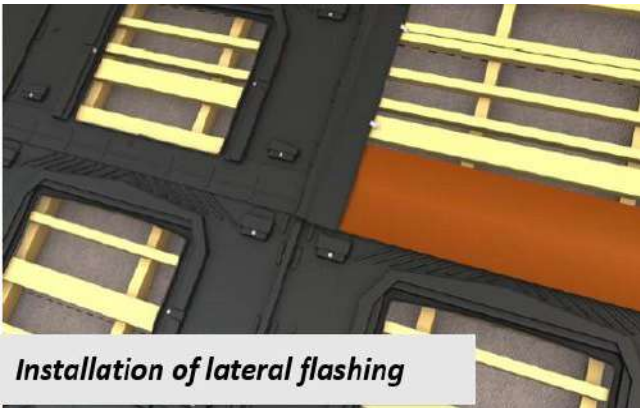
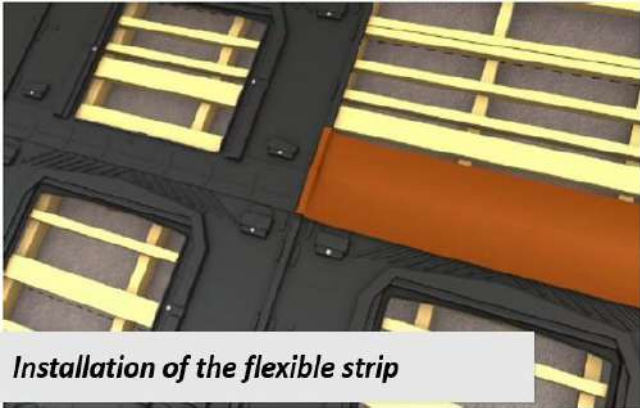

3.9.2 Outer Angle (T-Shaped)

Place the lateral flashing on the lower-row panel. Reposition the adjacent tiles to cover the lateral flashing, then place the flashing strip so that it overlaps with the last row of tiles, ensuring that there is a 2-cm fold in the upper section.

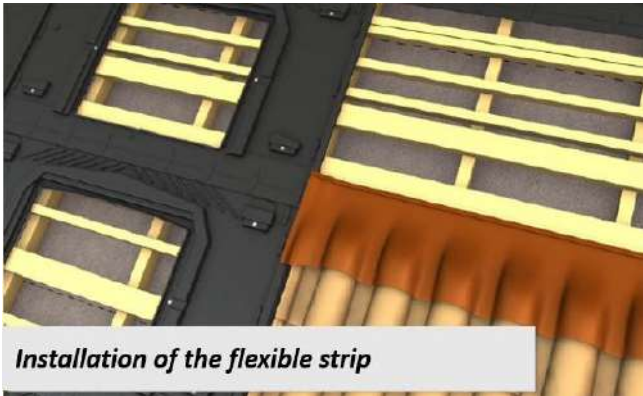
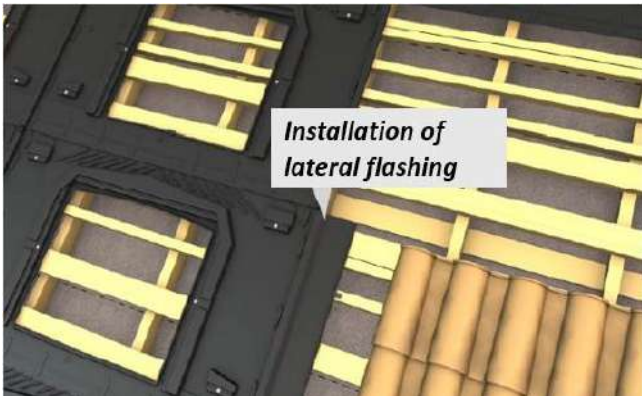

Then, position the GSE panel so that it's overlapping with the flashing strip.

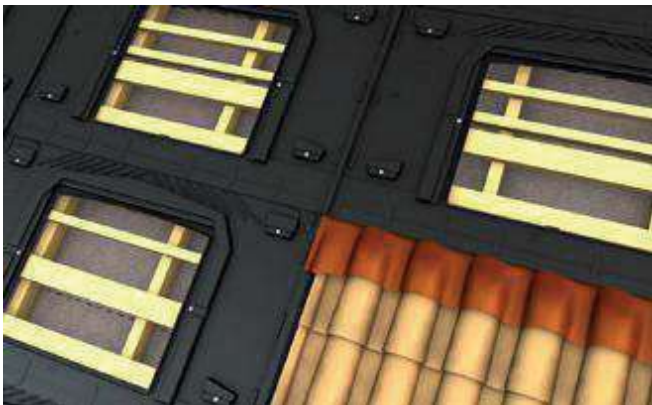

WARNING :
FOR THE OVERLAP, FOLLOW ROOFING
REGULATION AS WELL AS THE
REQUIREMENTS IN SECTIONS 3.4 AND
3.8 OF THIS DOCUMENT.

3.10 Connection to the roof covering

Reposition the lateral and upper sections of the roofing elements to make a continuous and watertight connection with the roof.



It may be necessary to cut the tiles to ensure a compliant overlap between the elements, according to roofing regulation. These elements must be attached mechanically, as described in the roofing regulation.

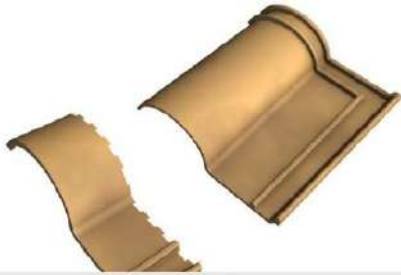

TIP:

YOU CAN USE DOUBLE TILES OR HALF TILES FOR THE LATERAL CONNECTION.

The roof tiles must rest on the flashings with enough overlap to meet the requirements of the roofing regulation.

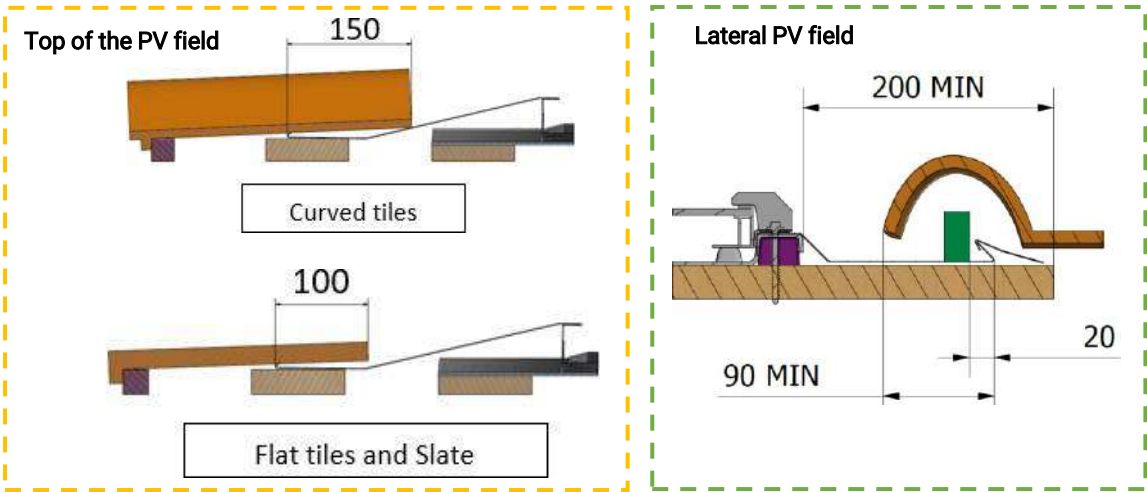

4. Maintenance and servicing

4.1 Verification



We recommend to check whether foreign materials have settled into the photovoltaic system and remove it manually if any. Simply use clean water to wash the GSE frames if needed.

For prevention, we also recommend that overall PV system installed is checked occasionally.

4.2 Module replacement

Disconnect the PV array from the AC box and proceed as follows:

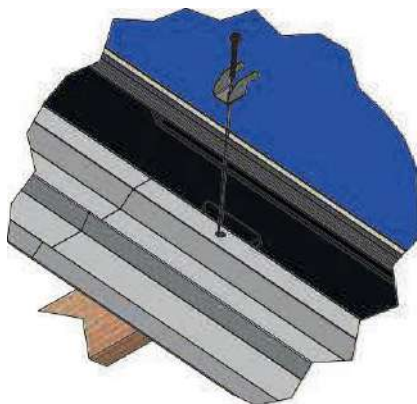

1. Unscrew the fixing clamp, remove the module and remove the edge wedges.



2. Screw one GSE screw at the location of old hole, having placed beforehand a new polypropylene edge wedges under the corrugation if it is located on an array edge.



3. Make a new 10 mm hole, 25 mm above the old position.



4. Place the module and attach the new assemblies (fixing clamp + EPDM foam + GSE screw).

5. Assistance and Contact

5.1 Training session

The GSE Integration team offers technical training sessions on the product with practical application on a demonstration model on your request and subject to the presence of a sufficient number of participants.

For further information, please contact your sales manager or distributor.



5.2 Technical assistance

TECHNICAL ASSISTANCE IS AVAILABLE
FROM MONDAY TO FRIDAY
FROM 9.30 AM TO 6 PM



5 rue Morand
93400 SAINT OUEN (France)
Tel.: +33(0)1.49.48.14.51

E-Mail: contact@gseintegration.com

6. Certifications and Warranties

6.1 Technical assessments

ETN n°A27T2021000B0

Avis Technique n°21-16/57

MCS 012 – KIWA 00041



6.2 Fire test

BRoof T1



BRoof T2



BRoof T3



BRoof T4



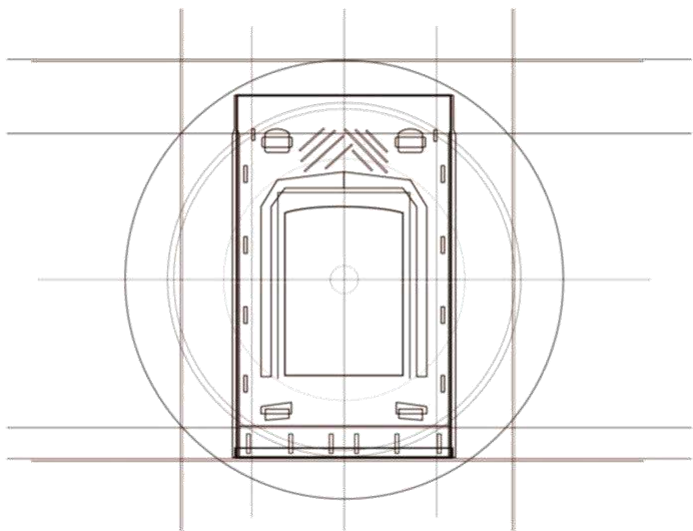

GSE IN-ROOF SYSTEM™

is a patented development project of GSE Intégration



Your
distributor:

Battening Plan – Landscape Frame H808

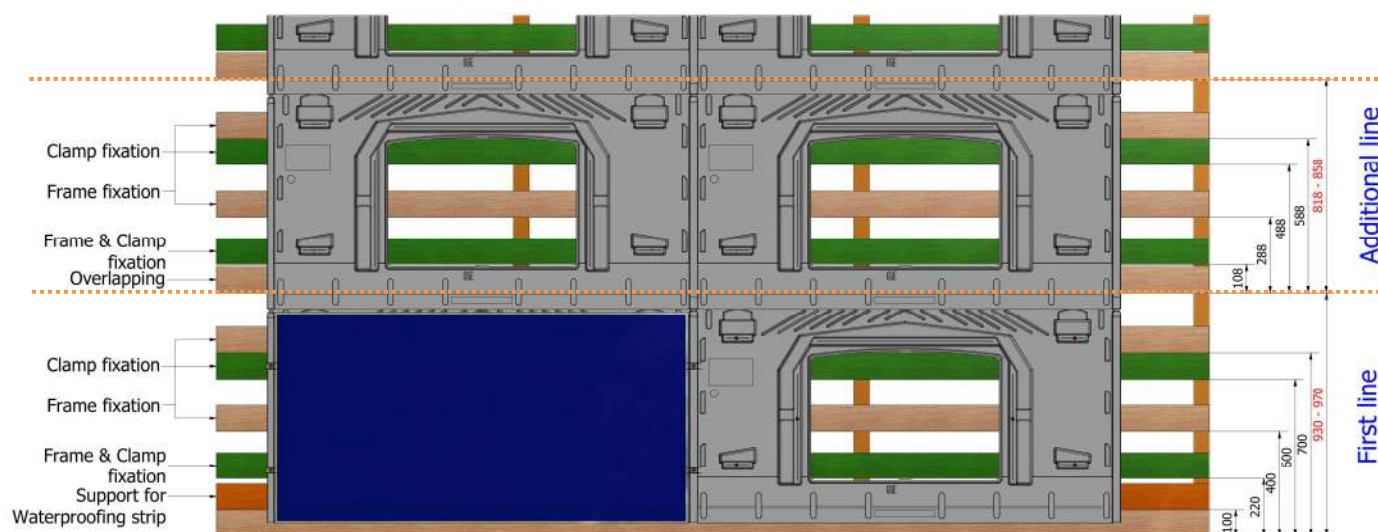

4 clamps

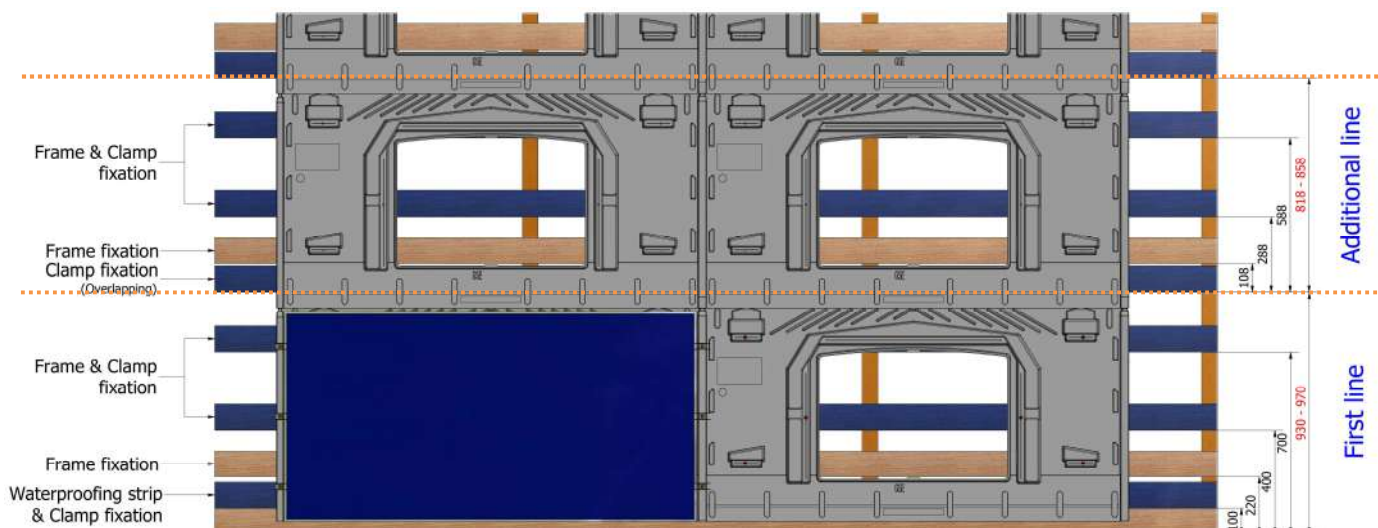

6 clamps

➤ **Batten width**¹ = 100mm

N.B.: the red dimension has to be adjusted according to the panel length:
(mm)

Panel length	First line	Additional line
≤808	930	818
818	940	828
828	950	838
838	960	848
848	970	858

¹ The dimension of the batten must comply with the Eurocode specifications according to the wind and snow zones of the Country. Recommendations are given in the installation manual of the GSE In-Roof System. For any questions, please, contact the technical support of GSE Integration.

Battening Plan – Landscape Frame H992

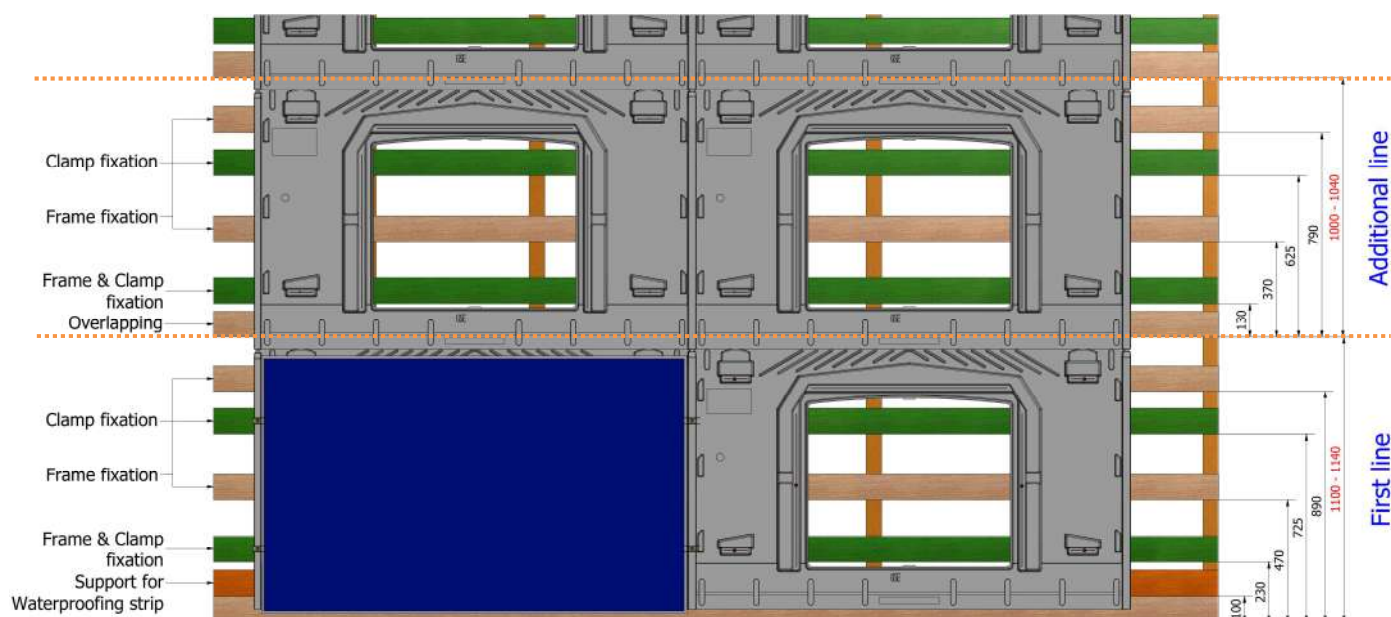

4 clamps

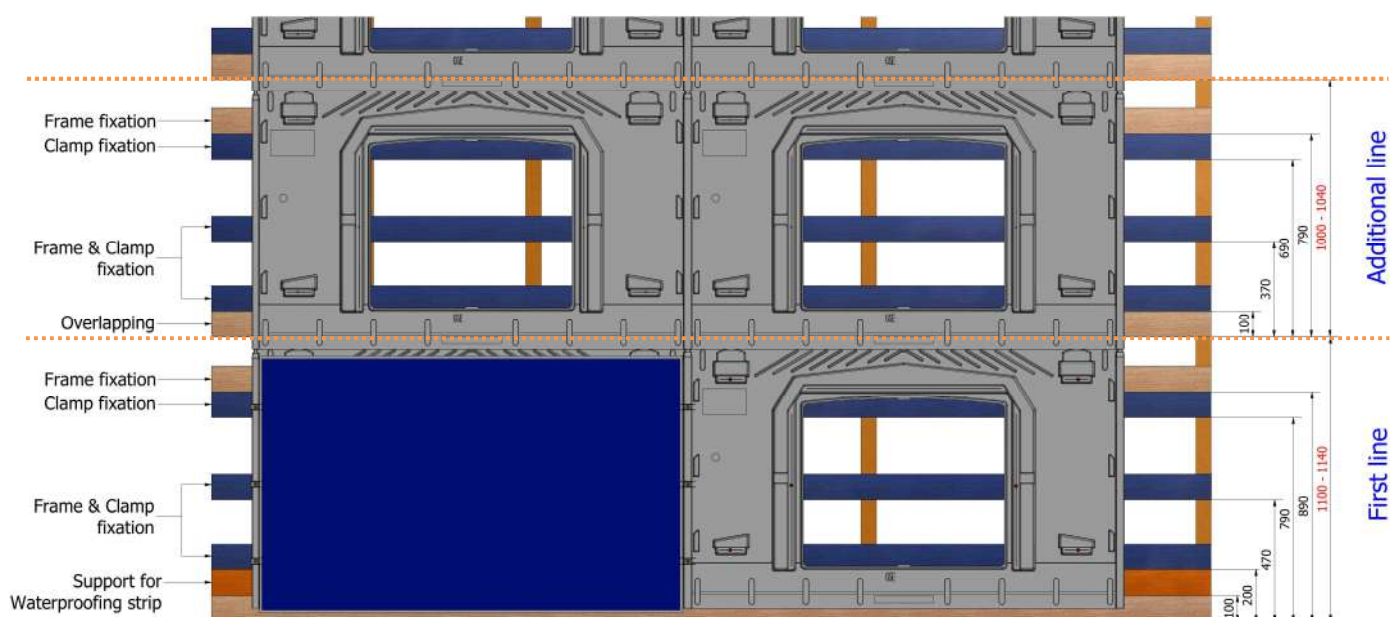

6 clamps

➤ Batten width¹ = 100mm

N.B.: the red dimension has to be adjusted according to the panel length:
(mm)

Panel length	First line	Additional line
≤992	1100	1000
1002	1110	1010
1012	1120	1020
1022	1130	1030
1032	1140	1040

¹ The dimension of the batten must comply with the Eurocode specifications according to the wind and snow zones of the Country. Recommendations are given in the installation manual. For any question, contact our technical department.

Battening Plan – Landscape Frame H1082

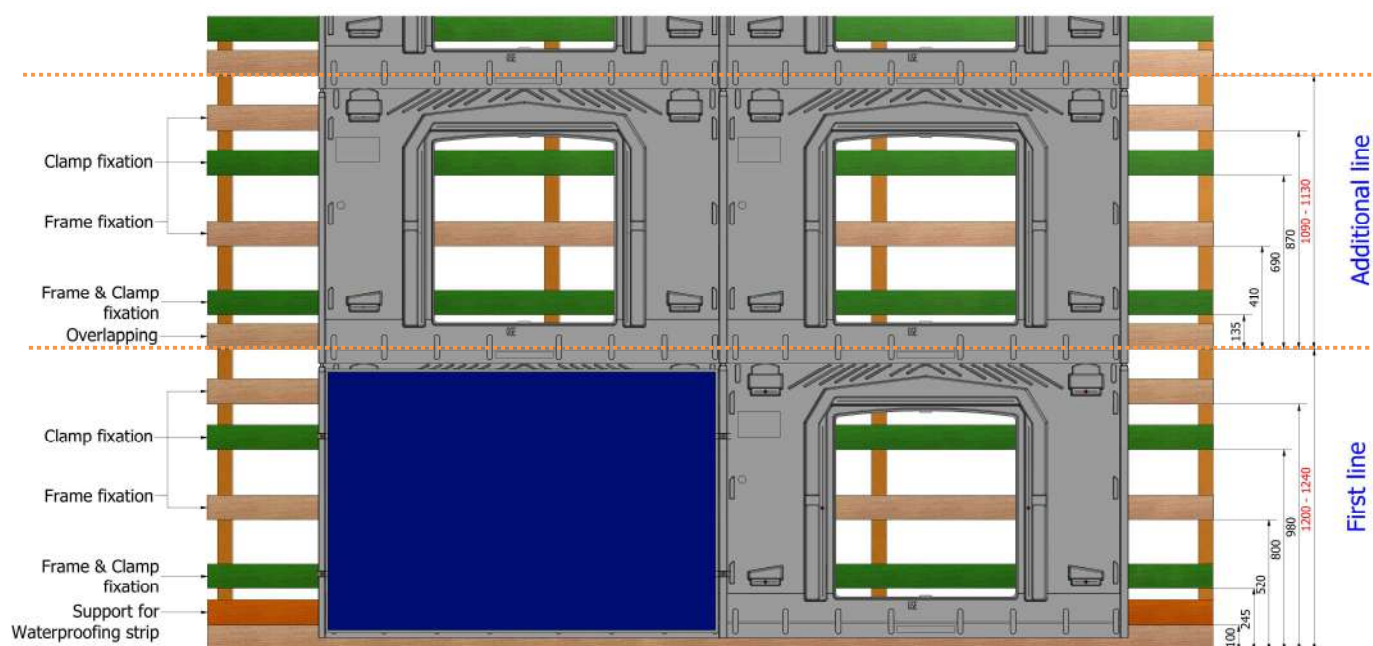

4 clamps

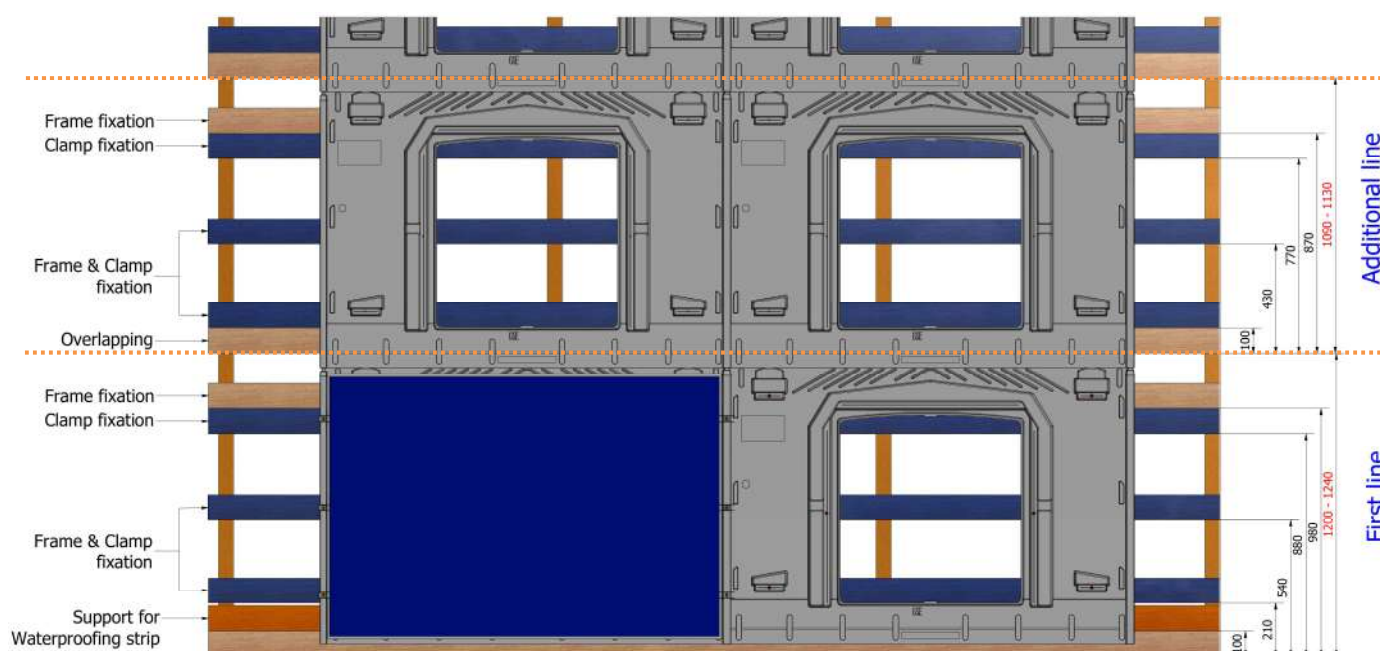

6 clamps

➤ **Batten width**¹ = 100mm

N.B.: the red dimension has to be adjusted according to the panel length: (mm)

Panel length	First line	Additional line
≤1082	1200	1090
1090	1210	1100
1100	1220	1110
1110	1230	1120
1120	1240	1130

¹ The dimension of the batten must comply with the Eurocode specifications according to the wind and snow zones of the Country. Recommendations are given in the installation manual of the GSE In-Roof System. For any questions, please, contact the technical support of GSE Integration.

Battening Plan – Portrait Frame H1575

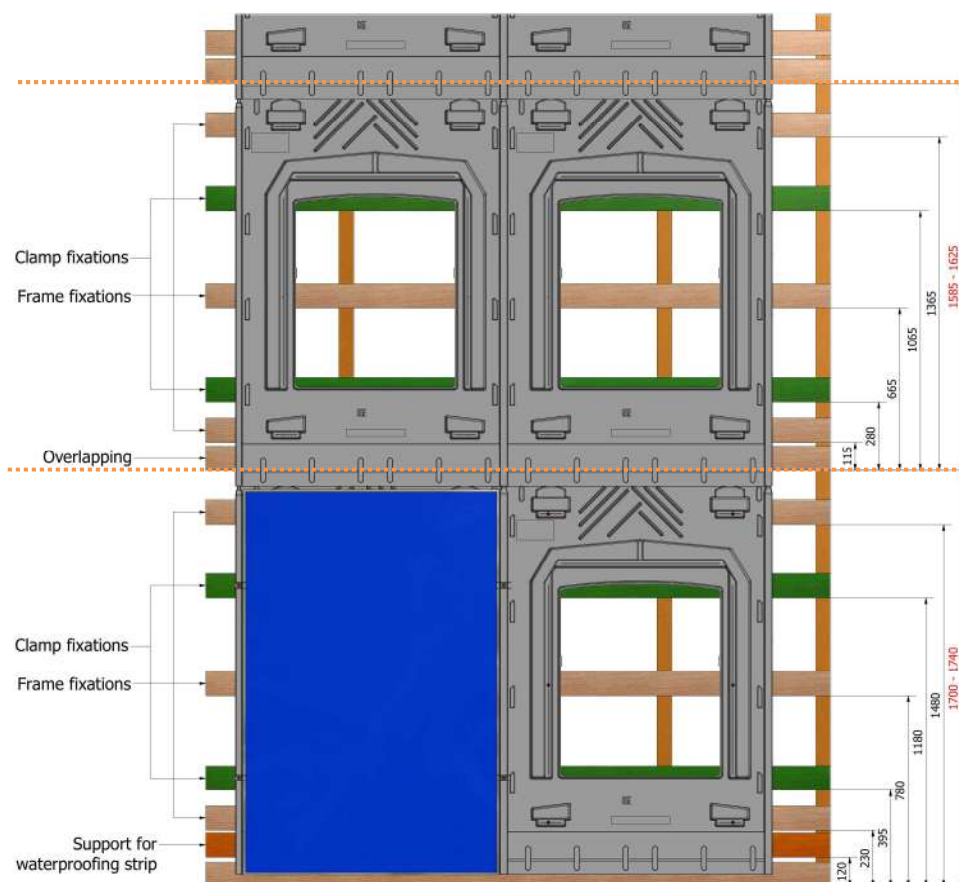

4 clamps

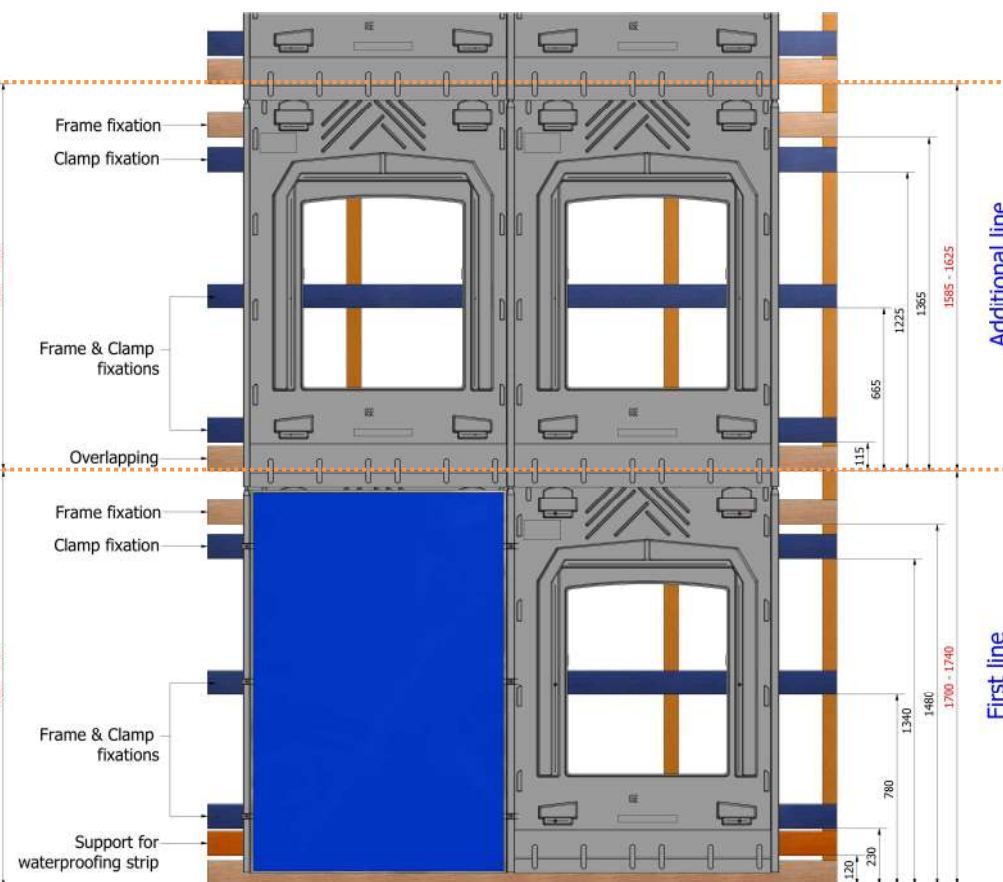

6 clamps

➤ **Batten width¹** = 100mm

N.B.: the red dimension has to be adjusted according to the panel length: (mm)

Panel length	First line	Additional line
≤1575	1700	1585
1585	1710	1595
1595	1720	1605
1605	1730	1615
1615	1740	1625

¹ The dimension of the batten must comply with the Eurocode specifications according to the wind and snow zones of the Country. Recommendations are given in the installation manual of the GSE In-Roof System. For any questions, please, contact the technical support of GSE Integration.

Battening Plan – Portrait Frame H1580

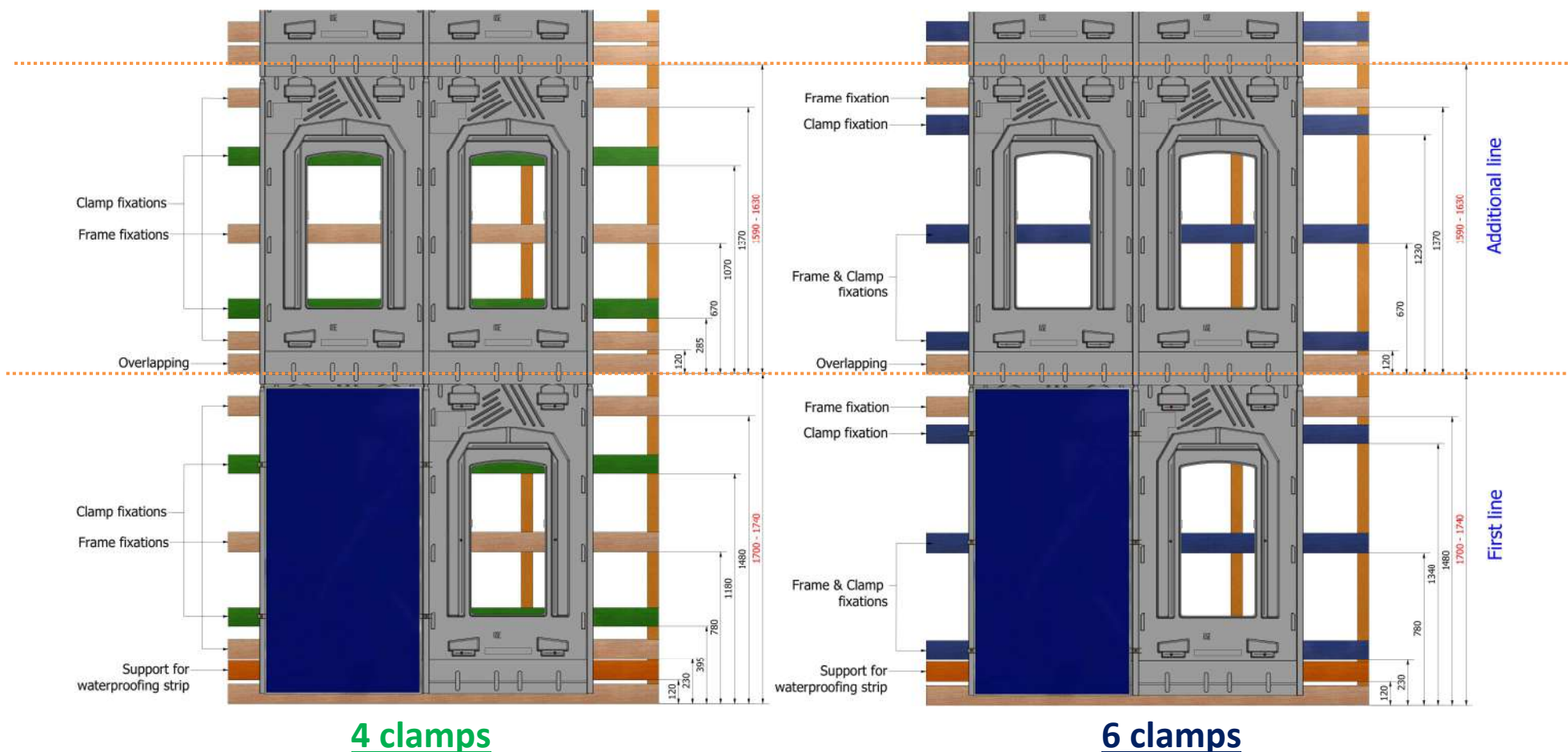

➤ **Batten width**¹ = 100mm

N.B.: the red dimension has to be adjusted according to the panel length: (mm)

Panel length	First line	Additional line
≤1580	1700	1590
1590	1710	1600
1600	1720	1610
1610	1730	1620
1620	1740	1630

¹ The dimension of the batten must comply with the Eurocode specifications according to the wind and snow zones of the Country. Recommendations are given in the installation manual of the GSE In-Roof System. For any questions, please, contact the technical support of GSE Integration.

Battening Plan – Portrait Frame H1640

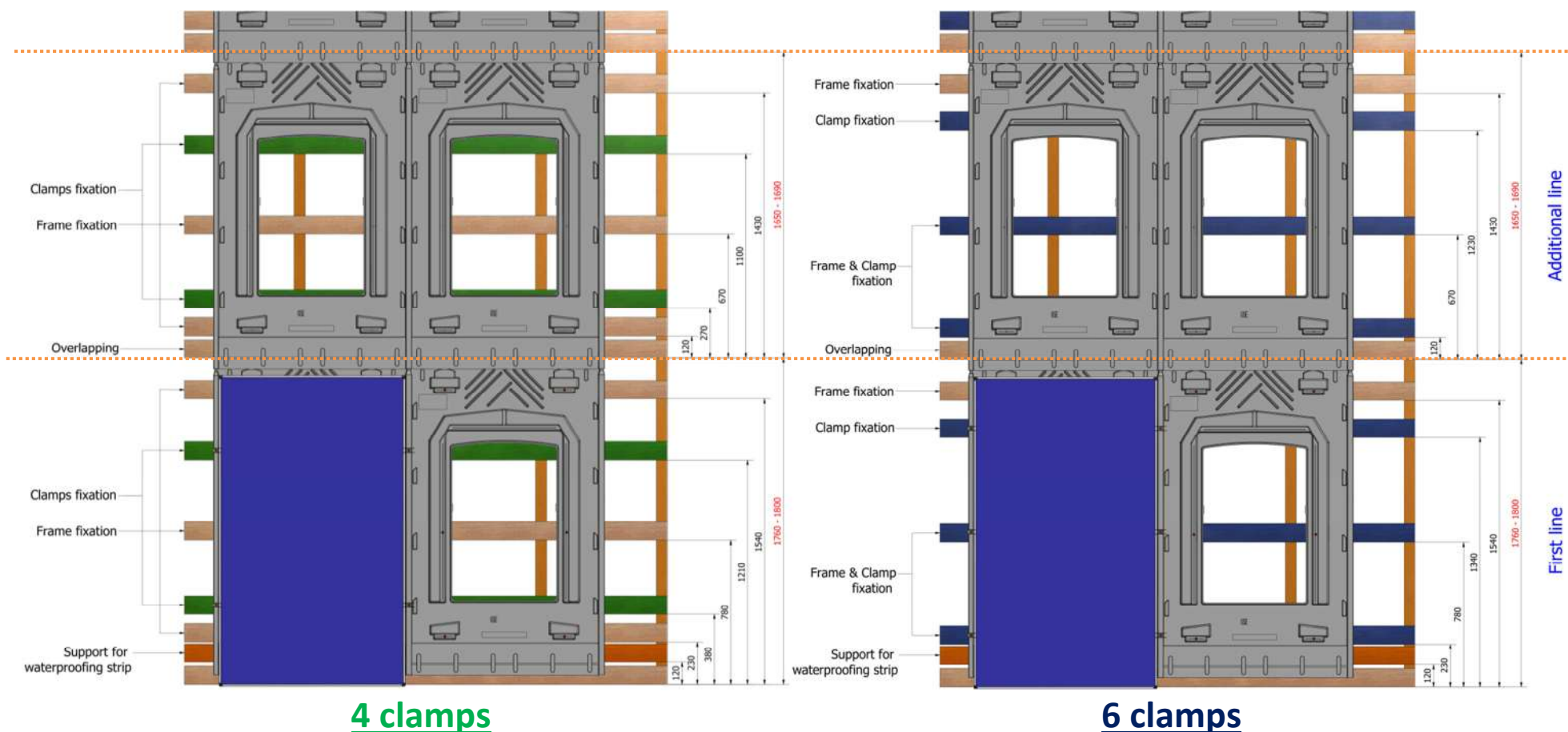

➤ **Batten width**¹ = 100mm

N.B.: the red dimension has to be adjusted according to the panel length: (mm)

Panel length	First line	Additional line
≤1640	1760	1650
1650	1770	1660
1660	1780	1670
1670	1790	1680
1680	1800	1690

¹ The dimension of the batten must comply with the Eurocode specifications according to the wind and snow zones of the Country. Recommendations are given in the installation manual of the GSE In-Roof System. For any questions, please, contact the technical support of GSE Integration.

GSE IN-ROOF SYSTEM™

BIPV system for photovoltaic panels

Installation guide

V 2.0

1 Calculation of PV array dimensions

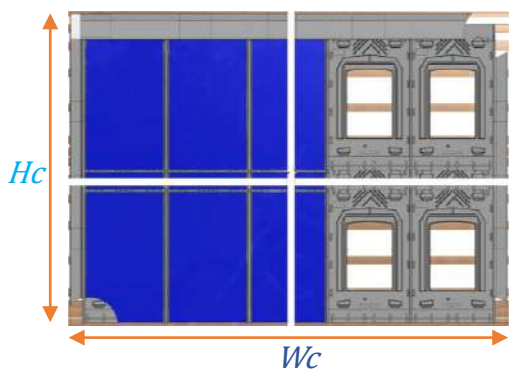

$$Hc (mm) = (Height Ref. + graduation) \times nb.rows + 310$$

$$Wc (mm) = (Width Ref. + 36.5) \times nb.columns + 310$$

Height Ref. / Width Ref. : depends on selected frame (see table below)

Graduation : depends on the length of the module (Height of the module – Height Ref of the GSE frame)

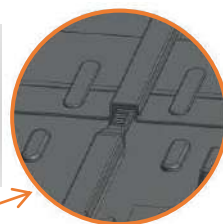

GSE frames - PORTRAIT																	
Height Ref	1580	1575	1575	1575	1640	1640	1686	1710	1710	1710	1710	1710	1710	1710	1710	1710	1710
Width Ref	808	1046	1053	1082	992	1001	1016	995	1000	1005	1010	1020	1025	1030	1040	1045	1050

GSE frames - LANDSCAPE																				
Height Ref	1082	1082	808	992	992	992	992	992	992	992*	992*	1020	1020	1020	1020	1020	1020	1020	1020	1020
Width Ref	1559	1575	1580	1640	1650	1660	1670	1675	1680	1686	1700	1665	1675	1680	1685	1690	1695	1700	1705	1740

2 Support battens of the mounting system

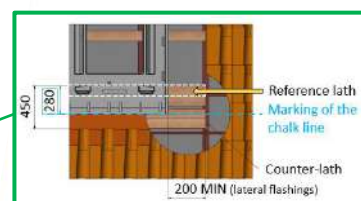
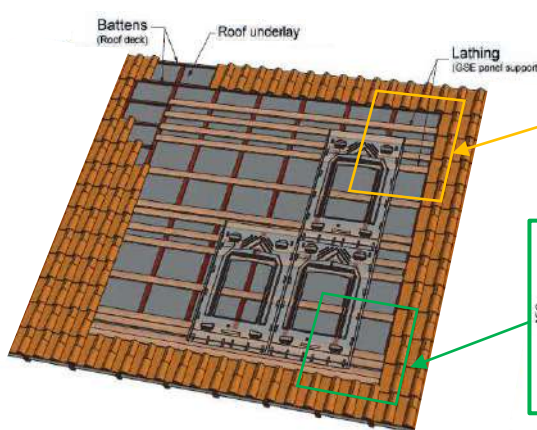
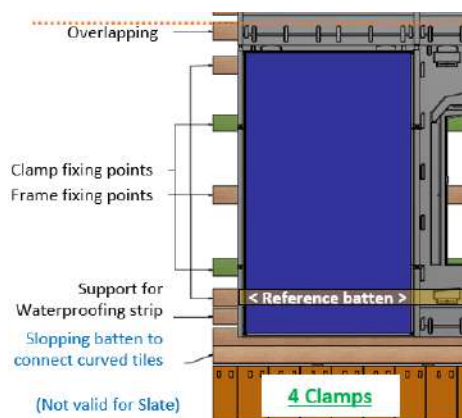

The sections of the support battens are determined according to climatic loads. Use roof battens only if the section is suitable to support climatic loads and if they are positioned according to the GSE battening plan (refer to the online documents)

Recommended batten section :27x100 (use minimum 25x50)

For other dimensions of sections, refer to the paragraphs 2.3.2 and 2.4.2 of the installation manual.

3 Junction to the lower roofing elements

A Junction in the middle of the roof

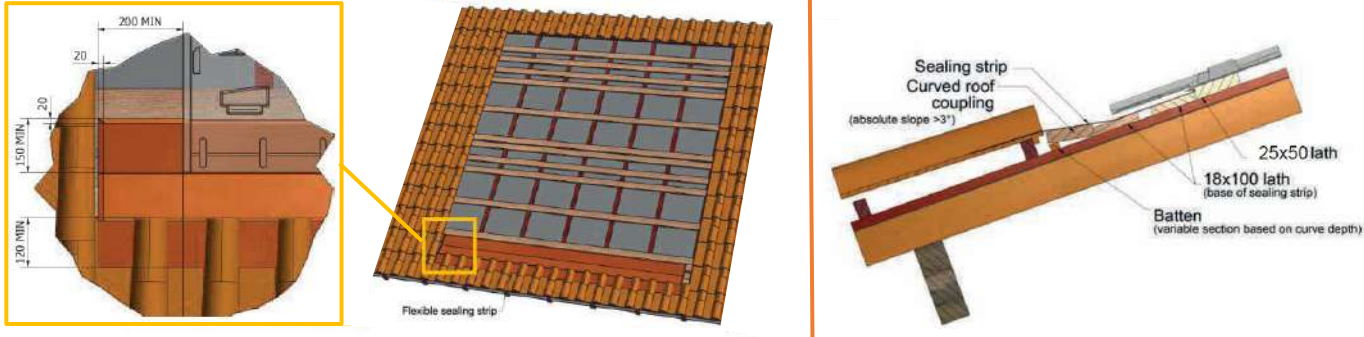

Laying of the waterproofing strip on:

Slate:

Other tiles:



TOP: the butyl strip of 2cm is laid under the frames

BOTTOM: the butyl strip of 10cm is laid on the tiles



B Junction to the gutter

When installing all the way to the eaves, the PV field can be connected directly to the gutter with a waterproofing strip or a drip flashing.

N.B.: the drip flashing isn't included in the GSE kit

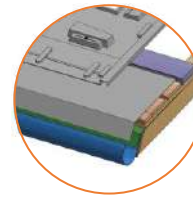

4 GSE frames grid

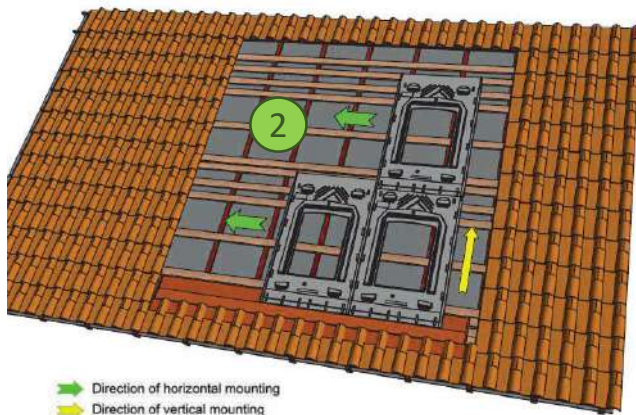

- 1 Fix the 1st frame through the 2 central fixing points
- 2 Assemble and fix the other frames
- 3 Pre-drill & fix the 4 other fixing points

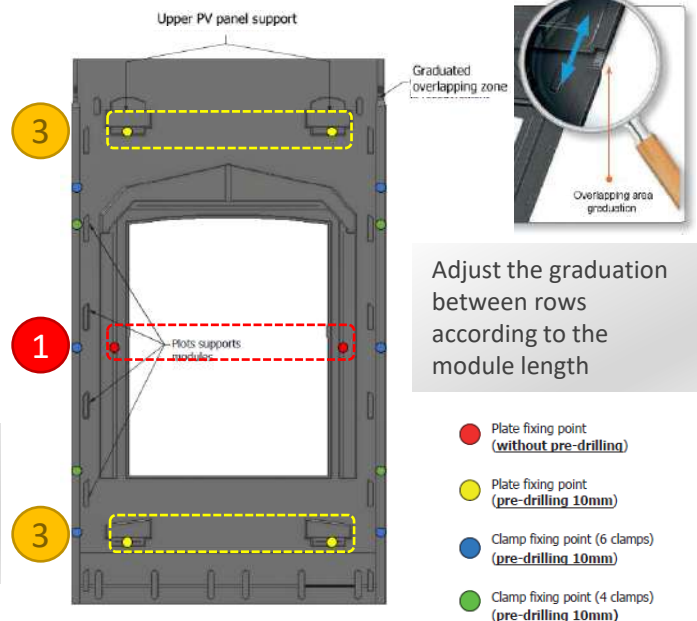

Adjust the graduation between rows according to the module length

- Plate fixing point (without pre-drilling)
- Plate fixing point (pre-drilling 10mm)
- Clamp fixing point (6 clamps) (pre-drilling 10mm)
- Clamp fixing point (4 clamps) (pre-drilling 10mm)



Warning: Do not screw too deep into the frame

5 Lateral flashings

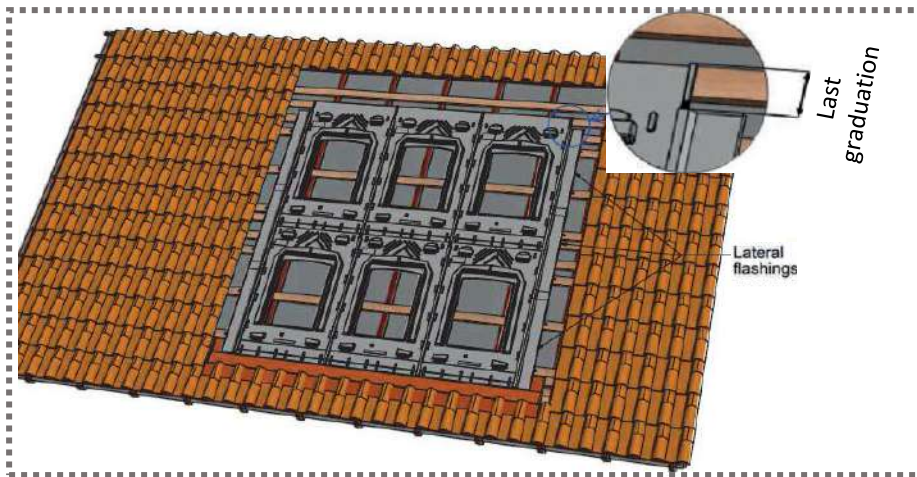

1 Place the wedges beneath the ridges of the frames

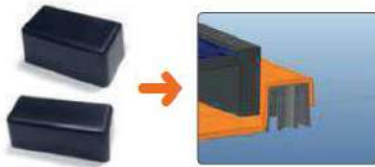

2 Flashings are placed on each other (150mm overlapping)

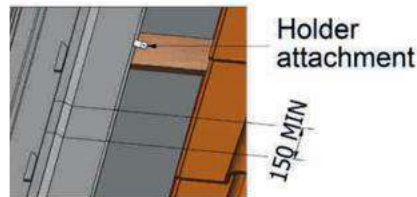

3 Straight to the clamps position, pre-drill through the flashing, plastic frame and wedge.



6 Solar panels

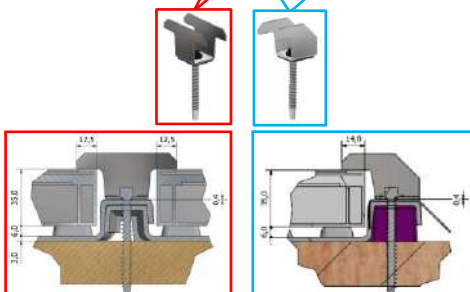
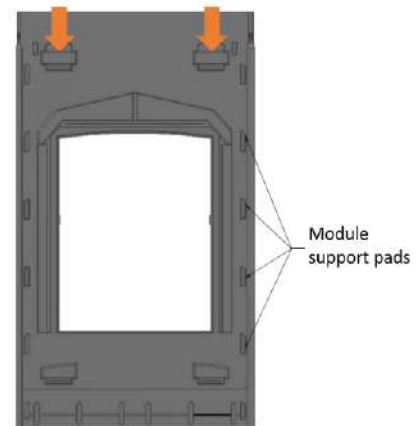
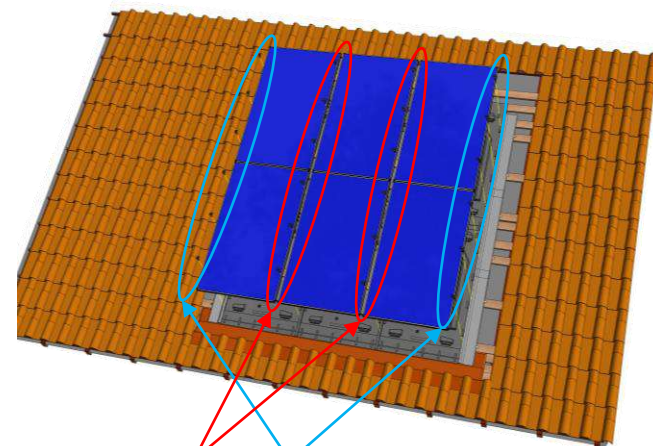

The module is maintained with the upper protrusions and must rest on the pads

Put EPDM foam beneath the clamps and pre-drill it with the screw

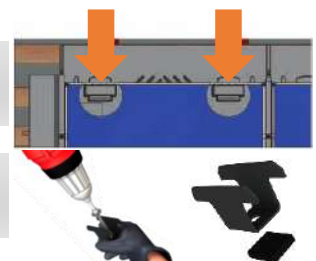

7 Top/corner flashings

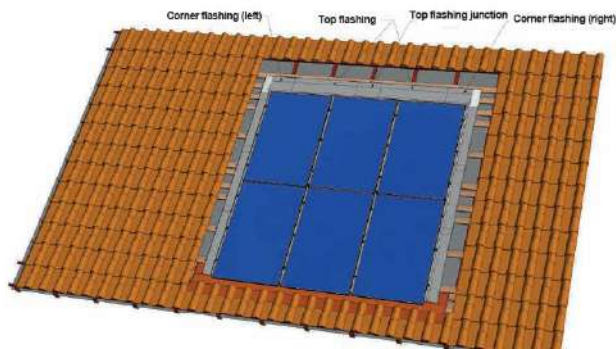

Position the attach angles and the top flashings so that it fits the module thickness. Make cuts on the attach angle at the position of the GSE panel corrugations.



Cut on the attach angle

Assemble the top flashing with the junction and the corner pieces.

Apply a seal joint at each junction between 2 pieces

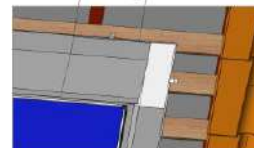
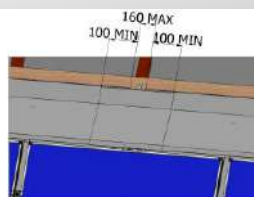
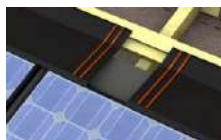

If needed, you will have to cut the corner flashings according to the GSE frame selected and the thickness of the module as defined in the following table:

Module thickness	30-34 mm	35-39 mm	40 et +
Frames 2012	Incompatible*	Needed cut	No cut needed
Frames 2020	Needed cut	No cut needed	Incompatible*

* Laying of a waterproofing strip on top of the PV field

Follow the 3 steps below to cut the corner flashings:

1

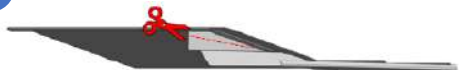

Cut the corner flashing in two distinct pieces

2

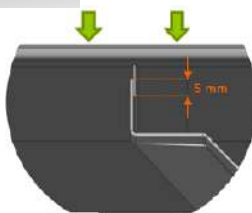

Adjust the height of the corner flashing by overlapping the two pieces

3

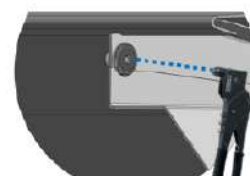

Once the height adjusted, drill the overlapped pieces with a 4,5mm drill bit and fix it with a rivet

8 Connection with roofing tiles

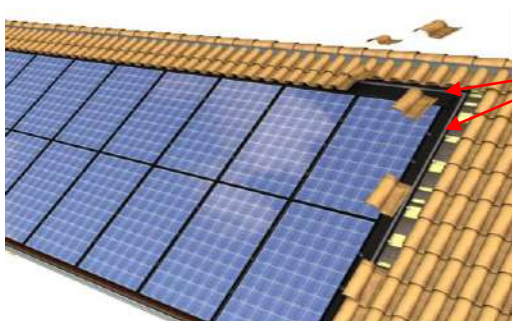

Place the pre-compressed foam on the top and lateral flashings

Cut the tiles if necessary. Double tiles can be used on lateral sides.

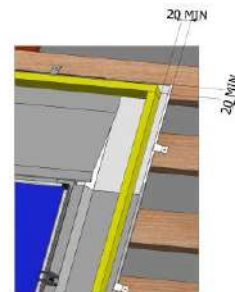

Lateral PV field

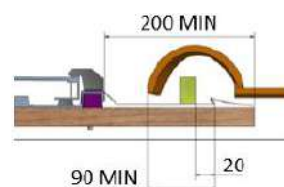

Top of the PV field

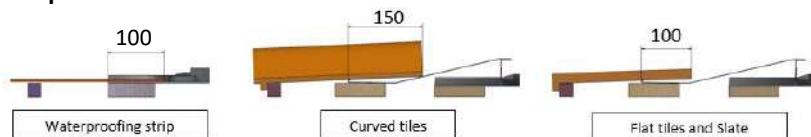

Technical support available :
Mon – Fri : 09:30 – 18:00

Whatsapp: +33 7.64.49.97.86
E-Mail: technical.support@gseintegration.com



Installation video Installation manual